

Olson Kundig

project;
SOMMET BLANC
33300 Marsac Ave (B2 East Parcel)
Grand Ciel, Utah 84080

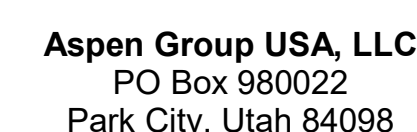

MEP Engineer
WSP USA
1001 Fourth Ave., Suite 3100
Seattle, WA 98154

principal architect _____
project manager _____
drawn by _____
checked by _____ Checker _____
job no. _____
date 11/18/2022

revisions

no.	date	to	from	amount	balance
1	1/1/19				
2	1/1/19				
3	1/1/19				
4	1/1/19				
5	1/1/19				
6	1/1/19				
7	1/1/19				
8	1/1/19				
9	1/1/19				
10	1/1/19				
11	1/1/19				
12	1/1/19				
13	1/1/19				
14	1/1/19				
15	1/1/19				
16	1/1/19				
17	1/1/19				
18	1/1/19				
19	1/1/19				
20	1/1/19				
21	1/1/19				
22	1/1/19				
23	1/1/19				
24	1/1/19				
25	1/1/19				
26	1/1/19				
27	1/1/19				
28	1/1/19				
29	1/1/19				
30	1/1/19				
31	1/1/19				
32	1/1/19				
33	1/1/19				
34	1/1/19				
35	1/1/19				
36	1/1/19				
37	1/1/19				
38	1/1/19				
39	1/1/19				
40	1/1/19				
41	1/1/19				
42	1/1/19				
43	1/1/19				
44	1/1/19				
45	1/1/19				
46	1/1/19				
47	1/1/19				
48	1/1/19				
49	1/1/19				
50	1/1/19				
51	1/1/19				
52	1/1/19				
53	1/1/19				
54	1/1/19				
55	1/1/19				
56	1/1/19				
57	1/1/19				
58	1/1/19				
59	1/1/19				
60	1/1/19				
61	1/1/19				
62	1/1/19				
63	1/1/19				
64	1/1/19				
65	1/1/19				
66	1/1/19				
67	1/1/19				
68	1/1/19				
69	1/1/19				
70	1/1/19				
71	1/1/19				
72	1/1/19				
73	1/1/19				
74	1/1/19				
75	1/1/19				
76	1/1/19				
77	1/1/19				
78	1/1/19				
79	1/1/19				
80	1/1/19				
81	1/1/19				
82	1/1/19				
83	1/1/19				
84	1/1/19				
85	1/1/19				
86	1/1/19				

ISSUE FOR
CONSTRUCTION
11/18/2022

TOWER A/B ELECTRICAL
LIGHTING PLAN - UNIT G

E3.4.G

SHEET NOTES:

- A. DRAWINGS ARE INTENDED TO SHOW GENERAL ARRANGEMENT, DESIGN AND EXTENT OF WORK AND ARE DIAGRAMMATIC. DRAWINGS ARE NOT INTENDED TO SHOW EXACT LOCATIONS EXCEPT WHERE DIMENSIONS ARE SHOWN. ELECTRICAL WORK IS SHOWN ON PLANS USING STANDARD SYMBOLS AND NOTATION. THE CONTRACTOR SHALL VERIFY THE COMMENCEMENT WITH WORK, VERIFY MEASUREMENTS PERTAINING THERETO AND ASSUME RESPONSIBILITY THEREFOR. ANY SUBSTANTIAL DIFFERENCES BETWEEN DRAWINGS AND CONDITIONS OF WORK SHALL BE REPORTED TO THE CONSTRUCTION MANAGER FOR CONSIDERATION BEFORE PROCEEDING WITH WORK.
- B. WORK PERFORMED INCLUDES LABOR, MATERIALS, AND EQUIPMENT REQUIRED TO INSTALL A COMPLETE ELECTRICAL SYSTEM IN ACCORDANCE WITH THE DRAWINGS AND ALL APPLICABLE ELECTRICAL CODES. THE CONTRACTOR SHALL OBTAIN ALL NECESSARY MATERIALS OR EQUIPMENT TO EMERGENCY POWER SOURCE AS INDICATED ON PLANS.
- C. REFER TO LUMINAIRE SCHEDULE FOR INFORMATION.
- D. FUTURE CABLE CLOSET NUMBERS ARE TO BE CHANGED BY LUMINAIRE. VERIFY FUTURE CABLE CLOSET NUMBERS FOR ACCURACY.
- E. VERIFY EQUIPMENT TYPES AND POWER REQUIREMENTS FOR EQUIPMENT PROVIDED BY OTHERS.
- F. ELECTRICAL CONDUITS IN FINISHED SPACES SHALL BE CONCEALED. COORDINATE WITH OTHER TRADES AND USE CHASES AND GELING SPACES. LOCATIONS OF ELECTRICAL JUNCTION BOXES IN FINISHED SPACES SHALL BE APPROVED BY ARCHITECT PRIOR TO ROUGH-IN.
- G. COORDINATE REMOTE DRIVE MOUNTING LOCATIONS WITH ARCHITECT PRIOR TO ROUGH

NUMBERED NOTES:

- 1 LUTRON WIRELESS PICO CONTROL SWITCH IS TO BE SUPPLIED AND INSTALLED FOR SWITCH CONTROL.
- 2 LIGHT FIXTURE LOCATED IN CLOSETS ARE TO BE CONTROLLED BY CLOSET DOOR JAMB SWITCH.
- 3 SUPPLY AND INSTALL LUTRON RADIO RAS SYSTEM TO PROVIDE PARTIAL LIGHTING CONTROL IN THE RESIDENTIAL UNITS. MASTER BEDROOM (DENIED AS BED 1) AND ALL ROOMS WITH MORE THAN THREE (3) LIGHTING CONTROL ZONES ARE TO BE CONTROLLED BY THE LUTRON RADIO RAS SYSTEM. ALL ROOMS WITH THREE (3) LIGHTING CONTROL ZONES OR LESS ARE TO BE CONTROLLED BY LOCAL DIMMERS.
- 4 SUPPLY AND INSTALL CEILING MOUNTED JUNCTION BOX COMPLETE WITH CAPPED LIGHTING CIRCUIT WIRING FOR INSTALLATION OF FUTURE CLOSET LIGHT FIXTURE.
- 5 PROVIDE TO ARCHITECTUTRY, DRAGS AND ELEVATIONS FOR EXACT DIMENSION AND MOUNTING LOCATION OF LIGHT FIXTURE TYPE, LOW. COORDINATE WITH MILLWORK CONTRACTOR PRIOR TO INSTALLATION.

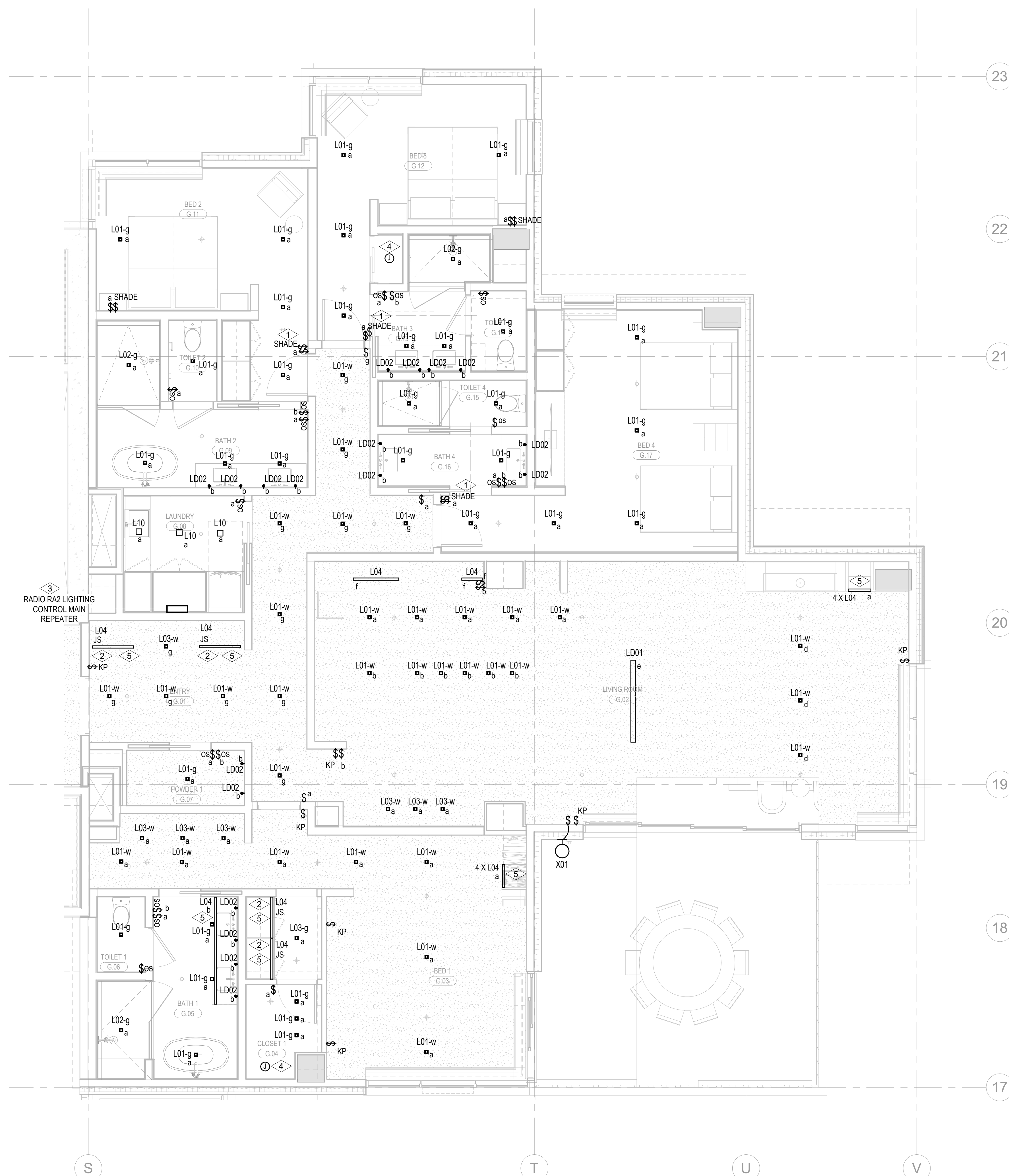

1 TOWER A/B - ELECTRICAL LIGHTING PLAN - UNIT G
SCALE: 1/4" = 1'-0"

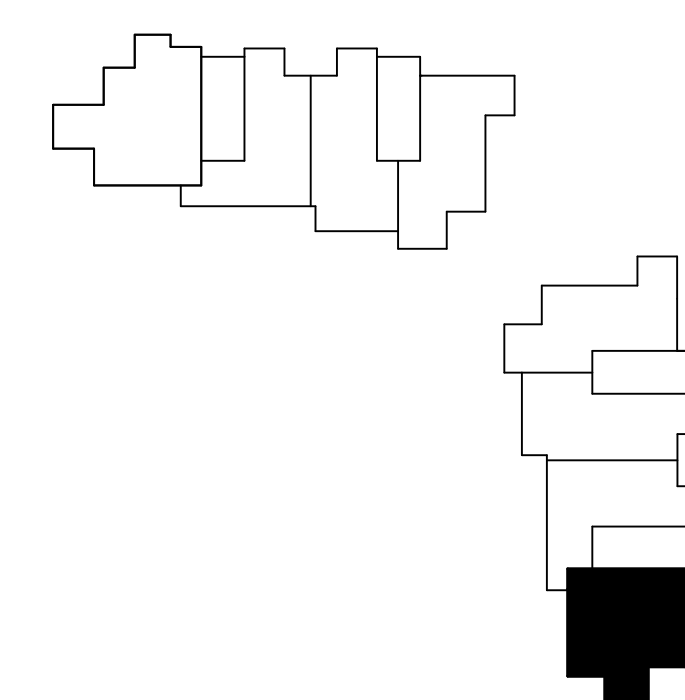

0 1' 2' 3' 4' 8' 1

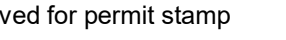

project:
Olson Kungaig



USA
Fourth Ave., Suite 3100
Seattle, WA 98154

ns:

Date _____ by _____

POWER A/B ELECTRICAL
LIGHTING PLAN - UNIT H

E3.4.H

A. DRAWINGS ARE INTENDED TO SHOW GENERAL ARRANGEMENT, DESIGN, AND EXTENT OF WORK AND ARE DIAGRAMMATIC. DRAWINGS ARE NOT INTENDED TO SHOW EXACT LOCATIONS, EXCEPT WHERE SHOWN. LOCATIONS OF ALL ELECTRICAL WORK IS SHOWN ON PLANS USING STANDARD INDUSTRY SYMBOLS. BEFORE ORDERING MATERIALS OR COMMENCEMENT WITH WORK, VERIFY MEASUREMENTS PERTAINING THERETO AND ASSUME RESPONSIBILITY THEREFOR. ANY SUBSTANTIAL DIFFERENCES BETWEEN DRAWINGS AND CONDITIONS IN THE FIELD SHALL BE SUBMITTED TO THE CONSTRUCTION MANAGER FOR CONSIDERATION BEFORE PROCEEDING WITH WORK.

B. ALL PERMANENTLY INSTALLED ELECTRICAL SYSTEMS ARE REQUIRED TO INSTALL A COMPLETE ELECTRICAL SYSTEM AS NOTICED ON DRAWINGS AND SPECIFICATIONS. PROVIDE EXIST SIGNS AND CONNECT EXIST SIGNS AND LUMINAIRES NOTED AS EMERGENCY EXITS. COORDINATE WITH ARCHITECT AS NECESSARY TO CHANGE.

C. REFER TO LUMINAIRE SCHEDULE FOR INFORMATION.

D. FUTURE CATALOG NUMBERS ARE SUBJECT TO CHANGE BY MANUFACTURER. VERIFY FUTURE CATALOG NUMBERS FOR ACCURACY.

E. EQUIPMENT SIZES AND POWER REQUIREMENTS FOR EQUIPMENT PROVIDED BY OTHERS.

F. ELECTRICAL CONDUITS IN FINISHED SPACES SHALL BE CONCEALED. COORDINATE WITH OTHER TRADES AND USE OF FINISHES. LOCATIONS OF ELECTRICAL JUNCTION BOXES IN FINISHED SPACES SHALL BE APPROVED BY ARCHITECT PRIOR TO ROUGH-IN.

G. COORDINATE REMOTE DIRECT MOUNTING LOCATIONS WITH ARCHITECT PRIOR TO ROUGH-IN.

2	LIGHT FIXTURE LOCATED IN CLOSETS ARE TO BE CONTROLLED BY CLOSET DOOR JAM SWITCH.
2	LURTON WIRELESS PICO CONTROL SWITCH IS TO BE SUPPLIED AND INSTALLED FOR SHADE CONTROL.
2	SUPPLY AND INSTALL LURTON RADIO RAZ SYSTEM TO PROVIDE PARTIAL LIGHTING IN THE RESIDENTIAL UNITS. MASTER BEDROOM IS TO BE CONTROLLED BY CLOSET LIGHT SWITCH. ALL OTHER ROOMS WITH MORE THAN THREE (3) LIGHTING CONTROL ZONES ARE TO BE CONTROLLED BY THE LURTON RADIO RAZ SYSTEM. ALL ROOMS WITH THREE (3) LIGHTING CONTROL ZONES OR LESS ARE TO BE CONTROLLED BY LOCAL DIMMERS.
2	SUPPLY AND INSTALL CEILING MOUNTED JAM SWITCHES WITH CAPPED LIGHTING CIRCUIT WIRING FOR INSTALLATION OF CLOSET LIGHT FIXTURES.
5	REFER TO ARCHITECTURAL DRAWINGS AND ELEVATIONS FOR EXACT DIMENSION AND MOUNTING LOCATION OF LIGHT FIXTURE TYPE L04. COORDINATE WITH MILLWORK CONTRACTOR PRIOR TO INSTALLATION.

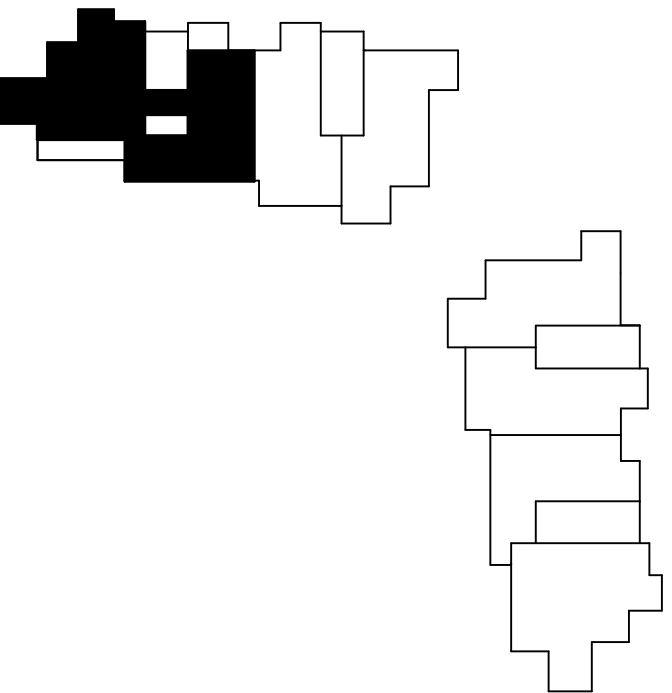

1 TOWER A/B - ELECTRICAL LIGHTING PLAN - UNIT H
SCALE: 1/4" = 1'-0"

SCALE: 1/4" = 1'-0"

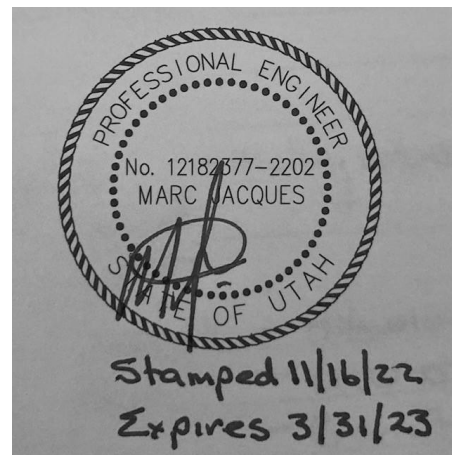

Reserved for permit stamp

109 South Jackson Street, Suite 800
Seattle, Washington 98104 USA
+1 206 834 5070 olsonkundig.com

Olson Kundig

project: **SOMMET BLANC**
9300 Marasc Ave (B2 East Parcel)
Park City, Utah 84060



Aspen Group USA, LLC
PO Box 980022
Park City, Utah 84098

Pool Consultant
Cloward M20
2696 N University Ave, Suite 290
Provo, UT 84604

Landscape Architect
EPG Design
6048 South High Tech Drive, Suite 100
Midvale, Utah 84047

Specifications Writer
Friday Group
86 Mainelli Road
Middlebury, VT

Code Consultant
Holmes
600 1st Avenue, Suite 200A
Seattle, WA 98104

Fire Protection Engineer
Jensen Hughes
One Research Drive, Suite 305C
Westborough, MA 01581

Vertical Transportation Consultant
Larch Bates
19515 North Creek Parkway, Suite 304
Bothell, WA 98011

Structural Engineer
Magnusson Klemencic Associates
1301 5th Ave, Suite 3200
Seattle, WA 98101

Lighting Designer
O
1319 SE MLK Blvd, Suite 210
Portland, Oregon 97219

Building Envelope Consultant
RDH
2101 N 34th St
Seattle, WA 98103

Accessibility Consultant
Studio Pacifica
2144 Westlake Ave N, Suite F
Seattle, WA 98109

MEP Engineer
WSP USA
1001 Fourth Ave., Suite 3100
Seattle, WA 98154

principal architect _____
project manager _____
drawn by _____
checked by _____
job no. _____
date 11/18/2022

revisions:

no. date by

ISSUE FOR
CONSTRUCTION
11/18/2022

TOWER A/B ELECTRICAL
LIGHTING PLAN - UNIT I

E3.4.I

SHEET NOTES:

- DRAWINGS ARE INTENDED TO SHOW GENERAL ARRANGEMENT, DESIGN, AND EXTENT OF WORK AND ARE DIAGRAMMATIC. DRAWINGS ARE NOT INTENDED TO SHOW EXACT LOCATIONS EXCEPT WHERE DIMENSIONS ARE SHOWN. ELECTRICAL WORK IS SHOWN ON PLANS USING STANDARD INDUSTRY SYMBOLS. BEFORE ORDERING MATERIALS OR COMMENCEMENT WITH WORK, VERIFY MEASUREMENTS PERTAINING THERETO AND ASSUME RESPONSIBILITY THEREFOR. ANY SUBSTANTIAL DIFFERENCES BETWEEN DRAWINGS AND CONDITIONS IN THE FIELD SHALL BE SUBMITTED TO THE CONSTRUCTION MANAGER FOR CONSIDERATION BEFORE PROCEEDING WITH WORK.
- WORK PERFORMED INCLUDES LABOR, MATERIALS, AND EQUIPMENT REQUIRED TO INSTALL A COMPLETE ELECTRICAL SYSTEM AS INDICATED ON DRAWINGS AND SPECIFICATIONS.
- PROVIDE EXIT SIGNS AND CONNECT EXIT SIGNS AND LUMINAIRES NOTED AS EMERGENCY TO EMERGENCY POWER SOURCE AS INDICATED ON PLANS.
- REFER TO LUMINAIRE SCHEDULE FOR INFORMATION.
- FIXTURE CATALOG NUMBERS ARE SUBJECT TO CHANGE BY MANUFACTURER. VERIFY FIXTURE CATALOG NUMBERS FOR ACCURACY.
- VERIFY EQUIPMENT SIZES AND POWER REQUIREMENTS FOR EQUIPMENT PROVIDED BY OTHERS.
- ELECTRICAL CONDUITS IN FINISHED SPACES SHALL BE CONCEALED. COORDINATE WITH OTHER TRADES AND USE CHASES AND CEILING SPACES. LOCATIONS OF ELECTRICAL JUNCTION BOXES IN FINISHED SPACES SHALL BE APPROVED BY ARCHITECT PRIOR TO ROUGH-IN.
- COORDINATE REMOTE DRIVER MOUNTING LOCATIONS WITH ARCHITECT PRIOR TO ROUGH-IN.

NUMBERED NOTES:

- LUTRON WIRELESS PICO CONTROL SWITCH IS TO BE SUPPLIED AND INSTALLED FOR SHADE CONTROL.
- LIGHT FIXTURE LOCATED IN CLOSETS ARE TO BE CONTROLLED BY CLOSET DOOR JAM SWITCH.
- SUPPLY AND INSTALL LUTRON RADIO RAZ SYSTEM TO PROVIDE PARTIAL LIGHTING CONTROL IN THE RESIDENTIAL UNITS. MASTER BEDROOM (DENOTED AS BED 1) AND ALL ROOMS WITH MORE THAN THREE (3) LIGHTING CONTROL ZONES ARE TO BE CONTROLLED BY THE LUTRON RADIO RAZ SYSTEM. ALL ROOMS WITH THREE (3) LIGHTING CONTROL ZONES OR LESS ARE TO BE CONTROLLED BY LOCAL DIMMERS.
- SUPPLY AND INSTALL CEILING MOUNTED JUNCTION BOX COMPLETE WITH CAPPED LIGHTING CIRCUIT WIRING FOR INSTALLATION OF FUTURE CLOSET LIGHT FIXTURE.
- REFER TO ARCHITECTURAL DRAWINGS AND ELEVATIONS FOR EXACT DIMENSION AND MOUNTING LOCATION OF LIGHT FIXTURE TYPE L04. COORDINATE WITH MILLWORK CONTRACTOR PRIOR TO INSTALLATION.



1 TOWER A/B - ELECTRICAL LIGHTING PLAN - UNIT I

SCALE: 1/4" = 1'-0"

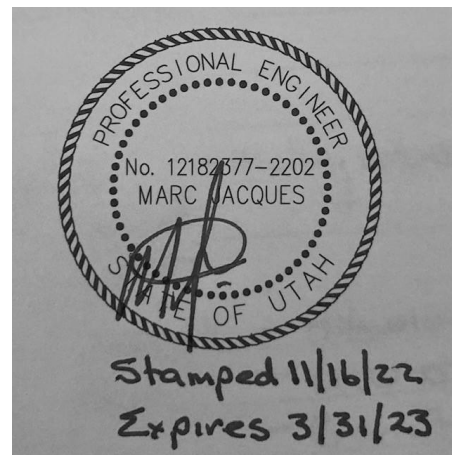

Reserved for permit stamp

100 South Jackson • Suite 800
Seattle, Washington 98104 USA
+1 206 834 5870 olsonkundig.com

Olson Kundig

project
SOMMET BLANC
9300 Marzac Ave (B2 East Parcel)
Park City, Utah 84060



Aspen Group USA, LLC
PO Box 980022
Park City, Utah 84098

Pool Consultant
Cloward M20
2696 N University Ave, Suite 290
Provo, UT 84604

Landscape Architect
EPG Design
6948 South High Tech Drive, Suite 100
Midvale, Utah 84047

Specifications Writer
Friday Group
86 Marrett Road
Middsbury, VT

Code Consultant
Holmes
600 1st Avenue, Suite 200A
Seattle, WA 98104

Fire Protection Engineer
Jensen Hughes
One Research Drive, Suite 305C
Westborough, MA 01581

Vertical Transportation Consultant
Larch Bates
19515 North Creek Parkway, Suite 304
Bothell, WA 98011

Structural Engineer
Magnusson Klemencic Associates
1301 5th Ave, Suite 3200
Seattle, WA 98101

Lighting Designer
O-
1319 SE MLK Blvd, Suite 210
Portland, Oregon 97219

Building Envelope Consultant
RDH
2101 N 34th St
Seattle, WA 98103

Accessibility Consultant
Studio Pacifica
2144 Westlake Ave N, Suite F
Seattle, WA 98109

MEP Engineer
WSP USA
1001 Fourth Ave., Suite 3100
Seattle, WA 98154

principal architect _____
project manager _____
drawn by _____
checked by _____
job no. _____
date 11/18/2022

revisions:

no. date by

ISSUE FOR
CONSTRUCTION
11/18/2022

TOWER A/B ELECTRICAL
LIGHTING PLAN - UNIT J

E3.4.J

SHEET NOTES:

- DRAWINGS ARE INTENDED TO SHOW GENERAL ARRANGEMENT, DESIGN, AND EXTENT OF WORK AND ARE DIAGRAMMATIC. DRAWINGS ARE NOT INTENDED TO SHOW EXACT LOCATIONS EXCEPT WHERE DIMENSIONS ARE SHOWN. ELECTRICAL WORK IS SHOWN ON PLANS USING STANDARD INDUSTRY SYMBOLS. BEFORE ORDERING MATERIALS OR COMMENCEMENT WITH WORK, VERIFY MEASUREMENTS PERTAINING THERETO AND ASSUME RESPONSIBILITY THEREFOR. ANY SUBSTANTIAL DIFFERENCES BETWEEN DRAWINGS AND CONDITIONS IN THE FIELD SHALL BE SUBMITTED TO THE CONSTRUCTION MANAGER FOR CONSIDERATION BEFORE PROCEEDING WITH WORK.
- WORK PERFORMED INCLUDES LABOR, MATERIALS, AND EQUIPMENT REQUIRED TO INSTALL A COMPLETE ELECTRICAL SYSTEM AS INDICATED ON DRAWINGS AND SPECIFICATIONS. PROVIDE EXIT SIGNS AND CONNECT EXIT SIGNS AND LUMINAIRES NOTED AS EMERGENCY TO EMERGENCY POWER SOURCE AS INDICATED ON PLANS.
- REFER TO LUMINAIRE SCHEDULE FOR INFORMATION.
- FIXTURE CATALOG NUMBERS ARE SUBJECT TO CHANGE BY MANUFACTURER. VERIFY FIXTURE CATALOG NUMBERS FOR ACCURACY.
- VERIFY EQUIPMENT SIZES AND POWER REQUIREMENTS FOR EQUIPMENT PROVIDED BY OTHERS.
- ELECTRICAL CONDUITS IN FINISHED SPACES SHALL BE CONCEALED. COORDINATE WITH OTHER TRADES AND USE CHASES AND CEILING SPACES. LOCATIONS OF ELECTRICAL JUNCTION BOXES IN FINISHED SPACES SHALL BE APPROVED BY ARCHITECT PRIOR TO ROUGH-IN.
- COORDINATE REMOTE DRIVER MOUNTING LOCATIONS WITH ARCHITECT PRIOR TO ROUGH-IN.



NUMBERED NOTES:

- LIGHT FIXTURE LOCATED IN CLOSETS ARE TO BE CONTROLLED BY CLOSET DOOR JAM SWITCH.
- LUTRON WIRELESS PICO CONTROL SWITCH IS TO BE SUPPLIED AND INSTALLED FOR SHADE CONTROL.
- SUPPLY AND INSTALL LUTRON RADIO RAZ SYSTEM TO PROVIDE PARTIAL LIGHTING CONTROL IN THE RESIDENTIAL UNITS. MASTER BEDROOM (DENOTED AS BED 1) AND ALL ROOMS WITH MORE THAN THREE (3) LIGHTING CONTROL ZONES ARE TO BE CONTROLLED BY THE LUTRON RADIO RAZ SYSTEM. ALL ROOMS WITH THREE (3) LIGHTING CONTROL ZONES OR LESS ARE TO BE CONTROLLED BY LOCAL DIMMERS.
- SUPPLY AND INSTALL CEILING MOUNTED JUNCTION BOX COMPLETE WITH CAPPED LIGHTING CIRCUIT WIRING FOR INSTALLATION OF FUTURE CLOSET LIGHT FIXTURE.
- REFER TO ARCHITECTURAL DRAWINGS AND ELEVATIONS FOR EXACT DIMENSION AND MOUNTING LOCATION OF LIGHT FIXTURE TYPE L04. COORDINATE WITH MILLWORK CONTRACTOR PRIOR TO INSTALLATION.

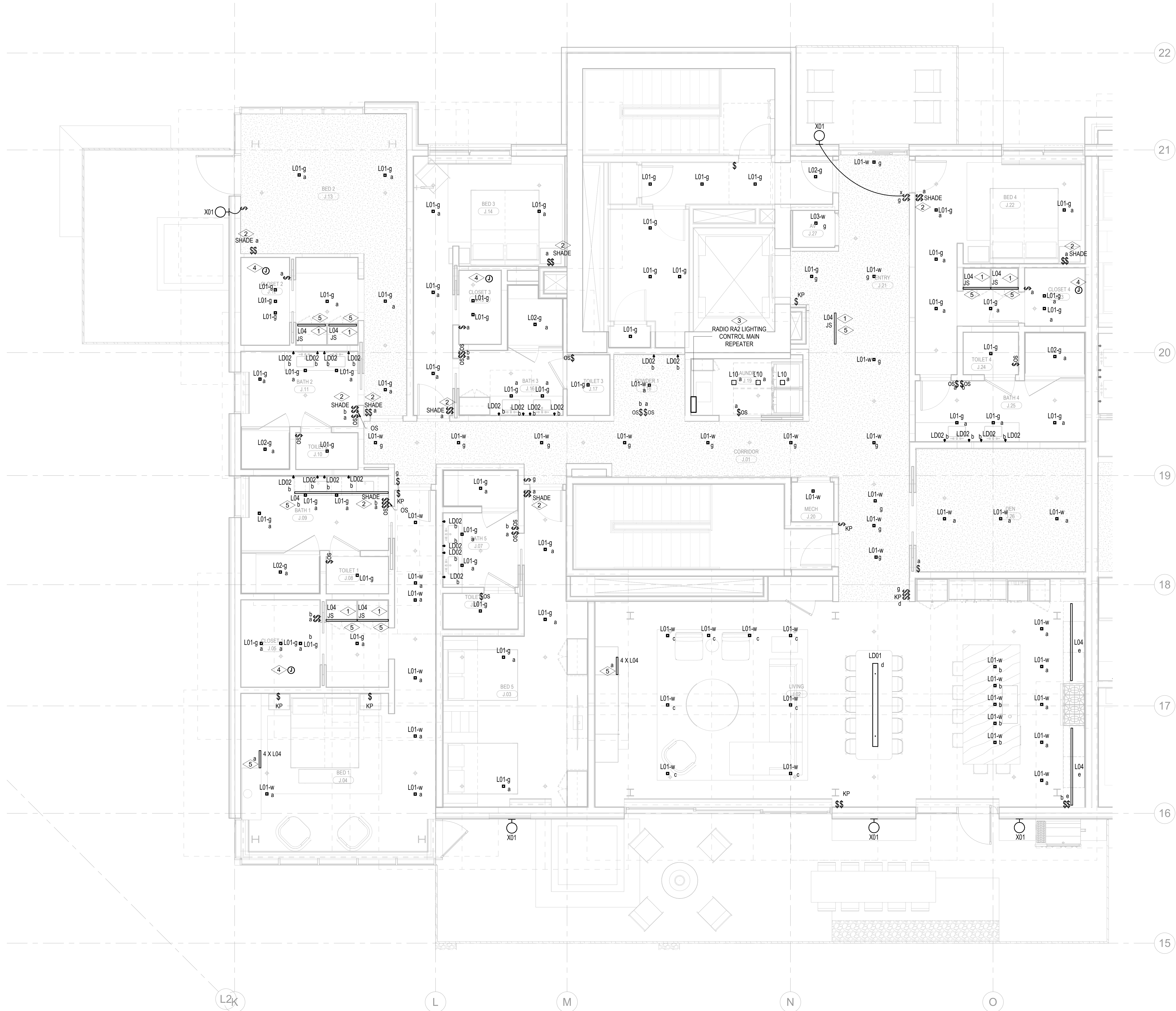

1 TOWER A/B - ELECTRICAL LIGHTING PLAN - UNIT J
SCALE: 1/4" = 1'-0"

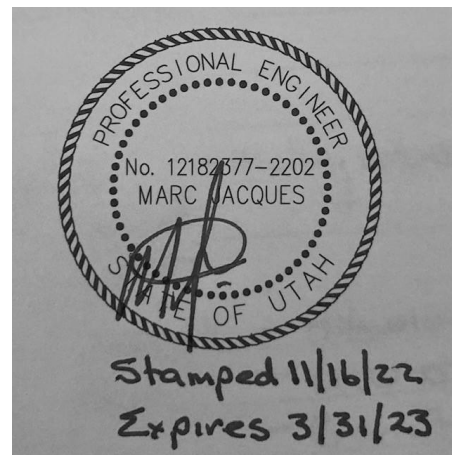

Reserved for permit stamp

100 South Jackson Street, Suite 800
Seattle, Washington 98104 USA
+1 206 834 5870
olsonkundig.com

Olson Kundig

project
SOMMET BLANC
9300 Marasc Ave (B2 East Parcel)
Park City, Utah 84060



Aspen Group USA, LLC
PO Box 980022
Park City, Utah 84098

Pool Consultant
Cloward M20
2696 N University Ave, Suite 290
Provo, UT 84604

Landscape Architect
EPG Design
6048 South High Tech Drive, Suite 100
Midvale, Utah 84047

Specifications Writer
Friday Group
86 Marrett Road
Middlebury, VT

Code Consultant
Holmes
600 1st Avenue, Suite 200A
Seattle, WA 98104

Fire Protection Engineer
Jensen Hughes
One Research Drive, Suite 305C
Westborough, MA 01581

Vertical Transportation Consultant
Larch Bates
19515 North Creek Parkway, Suite 304
Bothell, WA 98011

Structural Engineer
Magnusson Klemencic Associates
1301 5th Ave, Suite 3200
Seattle, WA 98101

Lighting Designer
O
1319 SE MLK Blvd, Suite 210
Portland, Oregon 97219

Building Envelope Consultant
RDH
2101 N 34th St
Seattle, WA 98103

Accessibility Consultant
Studio Pacifica
2144 Westlake Ave N, Suite F
Seattle, WA 98109

MEP Engineer
WSP USA
1001 Fourth Ave., Suite 3100
Seattle, WA 98154

principal architect _____
project manager _____
drawn by _____
checked by _____
job no. _____
date 11/18/2022

revisions:

no. date by

ISSUE FOR CONSTRUCTION
11/18/2022

TOWER A/B ELECTRICAL
LIGHTING PLAN - UNIT K

E3.4.K

SHEET NOTES:

- DRAWINGS ARE INTENDED TO SHOW GENERAL ARRANGEMENT, DESIGN, AND EXTENT OF WORK AND ARE DIAGRAMMATIC. DRAWINGS ARE NOT INTENDED TO SHOW EXACT LOCATIONS EXCEPT WHERE DIMENSIONS ARE SHOWN. ELECTRICAL WORK IS SHOWN ON PLANS USING STANDARD INDUSTRY SYMBOLS. BEFORE ORDERING MATERIALS OR COMMENCEMENT WITH WORK, VERIFY MEASUREMENTS PERTAINING THERETO AND ASSUME RESPONSIBILITY THEREFOR. ANY SUBSTANTIAL DIFFERENCES BETWEEN DRAWINGS AND CONDITIONS IN THE FIELD SHALL BE SUBMITTED TO THE CONSTRUCTION MANAGER FOR CONSIDERATION BEFORE PROCEEDING WITH WORK.
- WORK PERFORMED INCLUDES LABOR, MATERIALS, AND EQUIPMENT REQUIRED TO INSTALL A COMPLETE ELECTRICAL SYSTEM AS INDICATED ON DRAWINGS AND SPECIFICATIONS. PROVIDE EXIT SIGNS AND CONNECT EXIT SIGNS AND LUMINAIRES NOTED AS EMERGENCY TO EMERGENCY POWER SOURCE AS INDICATED ON PLANS.
- REFER TO LUMINAIRE SCHEDULE FOR INFORMATION.
- FIXTURE CATALOG NUMBERS ARE SUBJECT TO CHANGE BY MANUFACTURER. VERIFY FIXTURE CATALOG NUMBERS FOR ACCURACY.
- VERIFY EQUIPMENT SIZES AND POWER REQUIREMENTS FOR EQUIPMENT PROVIDED BY OTHERS.
- ELECTRICAL CONDUITS IN FINISHED SPACES SHALL BE CONCEALED. COORDINATE WITH OTHER TRADES AND USE CHASES AND CEILING SPACES. LOCATIONS OF ELECTRICAL JUNCTION BOXES IN FINISHED SPACES SHALL BE APPROVED BY ARCHITECT PRIOR TO ROUGH-IN.
- COORDINATE REMOTE DRIVER MOUNTING LOCATIONS WITH ARCHITECT PRIOR TO ROUGH-IN.

NUMBERED NOTES:

- LUTRON WIRELESS PICO CONTROL SWITCH IS TO BE SUPPLIED AND INSTALLED FOR SHADE CONTROL.
- LIGHT FIXTURE LOCATED IN CLOSETS ARE TO BE CONTROLLED BY CLOSET DOOR JAM SWITCH.
- SUPPLY AND INSTALL LUTRON RADIO RAZ SYSTEM TO PROVIDE PARTIAL LIGHTING CONTROL IN THE RESIDENTIAL UNITS. MASTER BEDROOM (NOTED AS BED 1) AND ALL ROOMS WITH MORE THAN THREE (3) LIGHTING CONTROL ZONES ARE TO BE CONTROLLED BY THE LUTRON RADIO RAZ SYSTEM. ALL ROOMS WITH THREE (3) LIGHTING CONTROL ZONES OR LESS ARE TO BE CONTROLLED BY LOCAL DIMMERS.
- SUPPLY AND INSTALL CEILING MOUNTED JUNCTION BOX COMPLETE WITH CAPPED LIGHTING CIRCUIT WIRING FOR INSTALLATION OF FUTURE CLOSET LIGHT FIXTURE.
- REFER TO ARCHITECTURAL DRAWINGS AND ELEVATIONS FOR EXACT DIMENSION AND MOUNTING LOCATION OF LIGHT FIXTURE TYPE L04. COORDINATE WITH MILLWORK CONTRACTOR PRIOR TO INSTALLATION.



1 TOWER A/B - ELECTRICAL LIGHTING PLAN - UNIT K

SCALE: 1/4" = 1'-0"