

CONCRETE PLAN GENERAL NOTES

1. WHERE WALLS ALIGN TO GRID, LOCATE FACE OF STUD OR FACE OF CONCRETE AT GRID, U.N.O.  
2. FINISH FLOOR ELEVATION TYPICAL, ABOVE SLAB LEVEL, U.N.O.  
3. REFER TO 40.10 AND 40.11 FOR ASSEMBLIES  
4. ALL DIMENSIONS ARE TO FACE OF CONCRETE AND CENTERLINE OF CONCRETE COLUMN, U.N.O.  
5. T.O. CURBS 4" A.F.F. MAXIMUM 6" A.F.F. WHERE SLAB IS SLOPED, U.N.O.  
6. MIN. 1% SLOPE TO DRAINS  
7. TOP OF CONCRETE SLAB ELEVATIONS PROVIDED FOR REFERENCE, CONTRACTOR SHALL COORDINATE WITH FINISH FLOOR ELEVATIONS PROVIDED ON ARCHITECTURAL PLANS AND ADJUST CONCRETE AS NECESSARY  
8. CEILING HEIGHTS MEASURED FROM TOP OF CONCRETE - SEE SECTIONS  
9. COORDINATE WITH ALL ENLARGED PLANS FOR ADDITIONAL INFORMATION AND DETAILS  
10. COORDINATE WITH STRUCTURAL FRAMING PLANS AND SHEAR WALL PLANS FOR SIZE, DETAILS, AND REINFORCING FOR COLUMNS, BEAMS, SHEAR WALLS, ETC.  
11. COORDINATE WITH ELECTRICAL DRAWINGS FOR ALL LIGHTING, POWER, AND DATA REQUIREMENTS  
12. COORDINATE WITH MECHANICAL DRAWINGS FOR ALL PLUMBING AND MECHANICAL PENETRATIONS

CONCRETE PLAN LEGEND

- SLAB PENETRATION  
SLAB STEP SYMBOL  
SLAB SLOPE SYMBOL  
CONCRETE SLAB - STRUCTURAL  
AREA OF RECESSED SLAB - STRUCTURAL / ARCHITECTURAL  
AREA OF OVERBUILT SLAB - ARCHITECTURAL

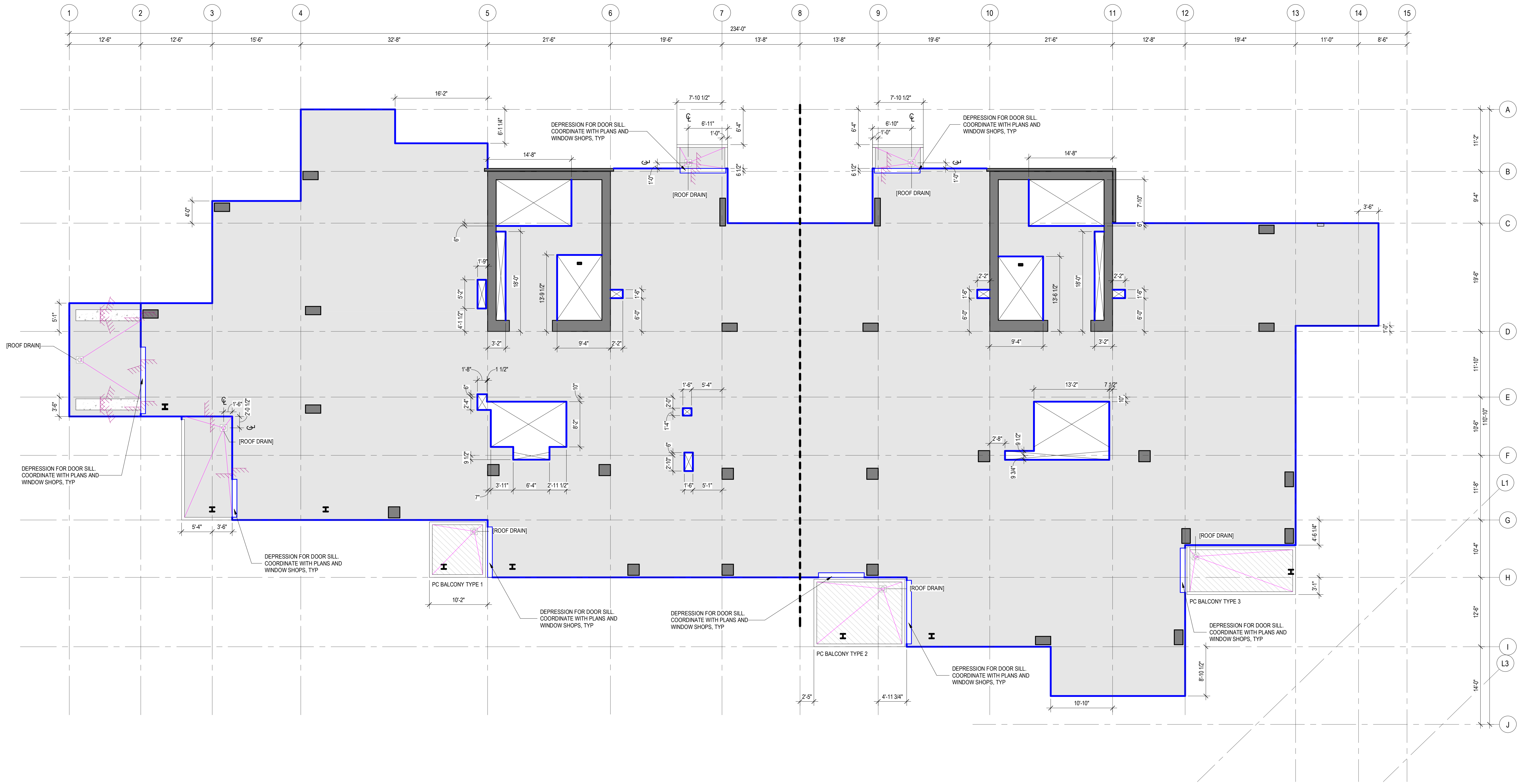

1 CONCRETE PLAN - TOWER A - LEVEL 3  
SCALE: 1/8" = 1'-0"

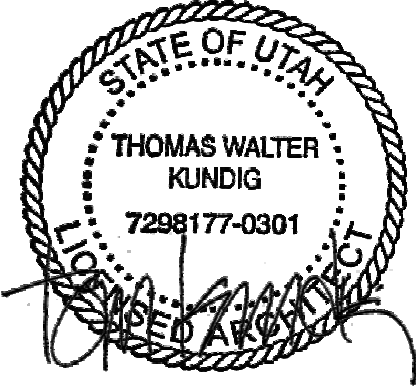
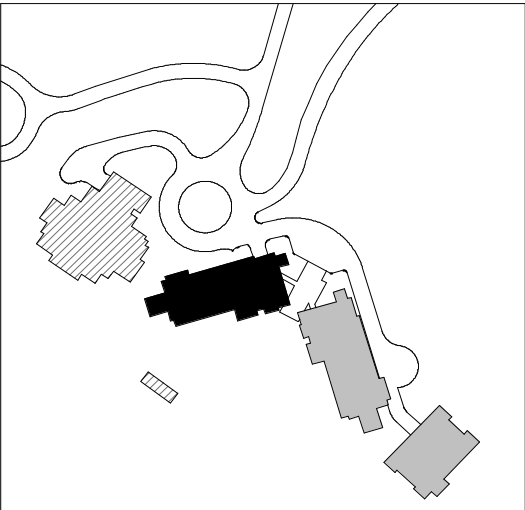

100 South Jackson St., Suite 600  
Seattle, Washington 98104 USA  
+1 206 834 6870 olsonkundig.com

Olson Kundig

SOMMET BLANC  
5500 PARASCA AVE  
PARK CITY, UT 84060



Aspen Group USA, LLC  
PO Box 980022  
Park City, Utah 84098

Pool Consultant  
Cloward H2O  
2006 N University Ave., Suite 290  
Provo, UT 84604

Landscape Architect  
EPG Design  
6949 South High Tech Drive, Suite 100  
Midvale, Utah 84047

Specifications Writer  
Friday Group  
88 Mainelli Road  
Middlebury, VT

Code Consultant  
Holmes  
800 1st Avenue, Suite 200A  
Seattle, WA 98104

Fire Protection Engineer  
Jensen Hughes  
One Research Drive, Suite 305C  
Westborough, MA 01581

Vertical Transportation Consultant  
Lerch Bates  
19515 North Creek Parkway, Suite 304  
Bellevue, WA 98011

Structural Engineer  
Magnusson Klemencic Associates  
1301 6th Ave., Suite 3200  
Seattle, WA 98101

Lighting Designer  
Q  
1319 SE MLK Blvd., Suite 210  
Portland, Oregon 97219

Building Envelope Consultant  
RDH  
2101 N 34th St  
Seattle, WA 98103

Accessibility Consultant  
Studio Pacifica  
2144 Westlake Ave N, Suite F  
Seattle, WA 98109

MEP Engineer  
WSP USA  
1501 Fourth Ave., Suite 3100  
Seattle, WA 98154

principal architect: TK, KM  
project manager: TM, JB, SL, MD  
drawn by: SK, SS, JR, CP, EA  
checked by: JB  
job no.: 20562  
date: 05/17/2024

revisions:  
no. date by

IFC SET 2 OF 3  
05/17/2024

CONCRETE PLAN -  
TOWER A - LVL 3

A2.1A.13