

1. SPOT VENTILATORS ARE RELATIVE TO FINISH FLOOR LEVEL AND INDICATE BOTTOM OF FINISH
2. ALL CEILINGS 9'-0" AFF U.N.O.
3. ALL CEILINGS ACCESSIBLE TO FINISH U.N.O.
4. ALL DIMENSIONS TO FACE OF FINISH U.N.O.
5. SEE CONCRETE PLANS FOR EXTENT OF CONCRETE SLABS AND BEAMS
6. ALL ROOMS, EXCEPT BATHS AND CORRIDORS SHALL HAVE A CEILING HEIGHT OF NOT LESS THAN 7 FEET AND 6 INCHES. BATHROOMS, TOILET ROOMS, KITCHENS, STORAGE ROOMS AND LAUNDRY ROOMS SHALL HAVE A CEILING HEIGHT OF NOT LESS THAN 8 FEET.
7. SEE SHEET 10.0 AND 10.11 FOR FLOORCEILING ASSEMBLIES.
8. SEE ELECTRICAL AND LIGHTING DRAWINGS FOR LIGHTING LAYOUTS AND ADDITIONAL INFORMATION NOT SHOWN ON THIS SHEET.
9. REFER TO MECHANICAL FOR SPRINKLER AND EXTINGUISHER TYPE AND FOR LOCATIONS.
10. ALL WALL-MOUNTED FIXTURES IN COMMON AREAS AND AMENITY LEVELS TO PROJECT 4" FROM WALL. WALL MOUNTED FIXTURES IN RESIDENTIAL AREAS TO PROJECT 1 1/2" FROM WALL.
11. SMOKE DETECTORS SHALL BE LOCATED A MINIMUM OF 3'-0" FROM SUPPLY AIR DIFFUSERS.
12. CANTER SPRINKLER HEAD LOCATIONS FROM LIGHTING FIXTURES AND/OR SMOKE DETECTORS SHALL BE MAINTAINED AS SHOWN ON MECHANICAL DRAWINGS. PROVIDE SIDE ARMS WHERE HEADS AND OTHER CEILING FIXTURES MAY BE IN CONFLICT. ALIGN ALL HEADS AND FIXTURES ORTHOGONALLY.
13. ALL LIGHTING LINES SHALL BE MAINTAINED AS SHOWN ABOVE DROPPED CEILINGS OR FITTED WITH FASTENING AND JOINT TAP AS REQUIRED FOR SPECIFIED RATING.
14. FIRE-RATED CEILINGS SHALL ALWAYS BE CONTINUOUS OVER CASCAPURRED-OUT ROOFING TO PREVENT FIRE FROM PENETRATING THROUGH ROOFING.
15. CEILING FASTENERS SHALL BE MAINTAINED AS SHOWN ABOVE DROPPED CEILING CAVITY. FIRESTOP ALL PENETRATIONS OF FIRE-RATED FLOORCEILING ASSEMBLIES.
16. SEE MECHANICAL DRAWINGS FOR ALL MECHANICAL DRAWINGS FOR ADDITIONAL INSULATION REQUIREMENTS AT DUCTS.
17. CEILING ACCESS PANELS ARE REQUIRED AT ALL DAMPERS, VALVES, TELECOM ACCESS POINTS AND SOME OTHER ACCESS POINTS. COORDINATE LOCATIONS PRIOR TO INSTALLATION OF ANY OF THESE SYSTEMS.

ELECTRICAL AND MECHANICAL INFORMATION ARE SHOWN FOR COORDINATION PURPOSES.
REFER TO MECHANICAL DRAWINGS AND ELECTRICAL DRAWINGS FOR GENERAL INFORMATION
AND LOCATIONS.

HATCH PATTERN INDICATE EXTENT OF CEILING TYPES
REFER TO CEILING ASSEMBLY FOR DETAIL INFORMATION

HATCH PATTERN INDICATE EXTENT OF CEILING TYPES
REFER TO CEILING ASSEMBLY FOR DETAIL INFORMATION

- | | |
|--|--|
| | WOOD CEILING |
| | SUSPENDED GYPSUM WALL BOARD |
| | STONE TILE |
| | ACOUSTICAL CEILING TILE |
| | PINNED INSULATION |
| | FABRIC PANEL PER GOLF SIMULATOR |
| | COMPOSITE METAL WALL PANEL |
| | SQUARE RECESSED DOWNLIGHT |
| | DECORATIVE SCONCE |
| | DECORATIVE CUSTOM CHANDELIER |
| | ROUND PENDANT LIGHT |
| | J-BOX |
| | LEASED LINEAR UTILITY STRIP |
| | CONCEALED LINEAR UNDERCABINET STRIP |
| | TRACK / RAIL / LINEAR LED |
| | SURFACE-MOUNTED LIGHT BAR |
| | SURFACE MOUNT PANEL |
| | SPRINKLER |
| | SMOKE DETECTOR |
| | COMBINATION SMOKE / CARBON MONOXIDE DETECTOR |
| | FIRE ALARM SPEAKER |
| | FIRE ALARM STROBE |
| | FIRE ALARM COMBINATION SPEAKER / STROBE |
| | COMBINATION SMOKE / HEAT DETECTOR |
| | EXIT SIGN |
| | SECURITY CAMERA |
| | WIRELESS ACCESS POINT |
| | AV SPEAKER |
| | MOTORIZED SINGLE ROLLER SHADE - EQ-02.00 |
| | MOTORIZED DOUBLE ROLLER SHADE - EQ-02.01 |
| | CEILING FAN - MECH EXHAUST |
| | MECHANICAL LINEAR GRILLE |
| | CEILING ACCESS PANEL |
| | CEILING CONTROL POINT |
| | ELEVATION CHANGE |
| | RETURN AIR GRILLE |

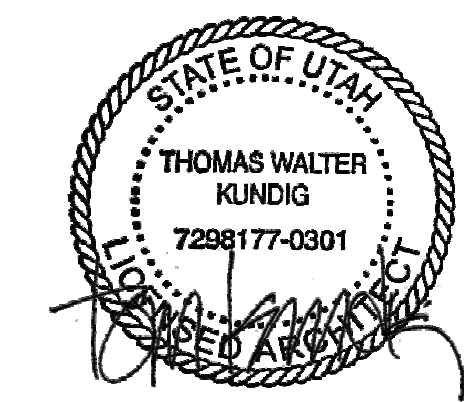

152 South Jackson St., Suite 600
Seattle, Washington 98104 USA
+1 206 624 5670 discontundg.com

Olson Kundig

SOMMET BLANC
9300 MARSAC AVE
PARK CITY, UT 84060



Aspen Group USA, LLC
PO Box 980022

Pool Consultant
Cloward H2O
2896 N University Ave, Suite 290
Provo, UT 84604

Landscape Architect
EPG Design
6949 South High Tech Drive, Suite 100
Midvale, Utah 84047

Specifications Writer
Friday Group
88 Mainelli Road
Middlebury, VT

Code Consultant
Holmes
600 1st Avenue, Suite 200
Seattle, WA 98104

Fire Protection Engineer
Jensen Hughes
One Research Drive, Suite
Westborough, MA 01581

Vertical Transportation Consultant
Lorch Bates
19515 North Creek Parkway, Suite 300
Bothell, WA 98011

Structural Engineer
Magnusson Klemencic Associates
1301 5th Ave, Suite 3200
Seattle, WA 98101

Lighting Designer
O-
1319 SE MILK Blvd, Suite 210
Portland, Oregon 97219

Building Envelope Consultant
RDH
2101 N 34th St
Seattle, WA 98103

Accessibility Consultant
Studio Pacifica
2144 Westlake Ave N, Suite F
Seattle, WA 98109

MEP Engineer
WSP USA
1001 Fourth Ave., Suite 3100
Seattle, WA 98154

principal architect TK, KM
project manager TM, JB, SL, MD
drawn by SK, SS, JR, CP, EA
JF, BD

checked by JB
job no. 20162
date 06/21/06

revisions:

[illegible]

no.	date	by
-----	------	----

IFC SET 3 OF 3
05/31/2024

RCP - TOWER B - LVL B

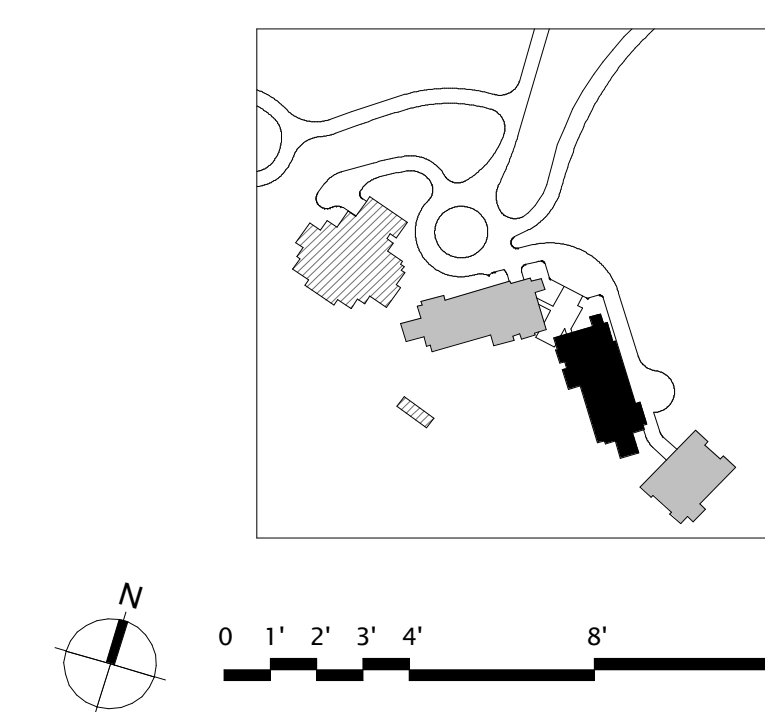

1 TOWER B LVL B
SCALE: 1/4" = 1'-0"