

159 South Jackson St, Suite 600
Seattle, Washington 98104 USA
1 206 624 5670 osorkundig.com

project: **SOMMET BLANC**
3300 Marsac Ave (B2 East Parcel)

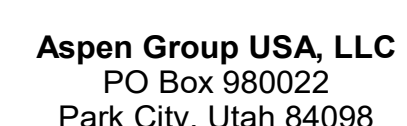

MEP Engineer
WSP USA
1001 Fourth Ave., Suite 3100
Seattle, WA 98154

revisions:

E3.2B.02

A. DRAWINGS ARE INTENDED TO SHOW GENERAL ARRANGEMENT, DESIGN, AND EXTENT OF WORK AND ARE DIAGRAMMATIC. DRAWINGS ARE NOT INTENDED TO SHOW EXACT LOCATIONS EXCEPT WHERE DIMENSIONS ARE SHOWN. ELECTRICAL WORK IS SHOWN ON A STANDARD GRID. THE CONTRACTOR SHALL BE RESPONSIBLE FOR OBTAINING MATERIALS, COMMENCEMENT WITH WORK, VERIFY MEASUREMENTS PERTAINING THERETO AND ASSUME RESPONSIBILITY THEREFOR. ANY UNUSUAL DIFFERENCES BETWEEN THE DRAWINGS AND CONDITIONS OF THE PROJECT SHALL BE REPORTED IMMEDIATELY TO THE PROJECT MANAGER FOR CONSIDERATION BEFORE PROCEEDING WITH WORK.

B. THE CONTRACTOR SHALL BE RESPONSIBLE FOR OBTAINING ALL PERMITS REQUIRED TO INSTALL A COMPLETE ELECTRICAL SYSTEM AS INDICATED ON DRAWINGS AND SPECIFICATIONS.

C. PROVIDE EXIST SINGS AND CONNECT EXIST SINGS AND LUMINAIRES NOT AS EMERGENCY LIGHTS TO POWER SUPPLY. PROVIDE EXIST SINGS AND LUMINAIRES NOT AS EMERGENCY LIGHTS TO POWER SUPPLY.

D. REFER TO LUMINAIRE SCHEDULE FOR INFORMATION.

E. FUTURE CATALOG NUMBERS ARE SUBJECT TO CHANGE BY MANUFACTURER. VERIFY CATALOG NUMBERS WITH MANUFACTURER.

F. VERIFY EQUIPMENT SIZES AND POWER REQUIREMENTS FOR EQUIPMENT PROVIDED BY OTHERS.

G. VERIFY ALL CONDUITS IN FINISHED SPACES SHALL BE CONCEALED. COORDINATE WITH OTHER TRADES AND USE CHASES AND CEILING SPACES. LOCATIONS OF ELECTRICAL JUNCTION BOXES IN FINISHED SPACES SHALL BE APPROVED BY ARCHITECT PRIOR TO PO

NUMBERED NOTES:

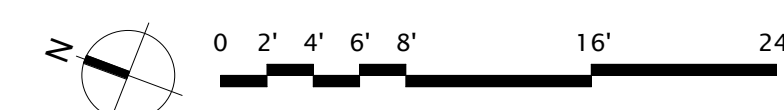
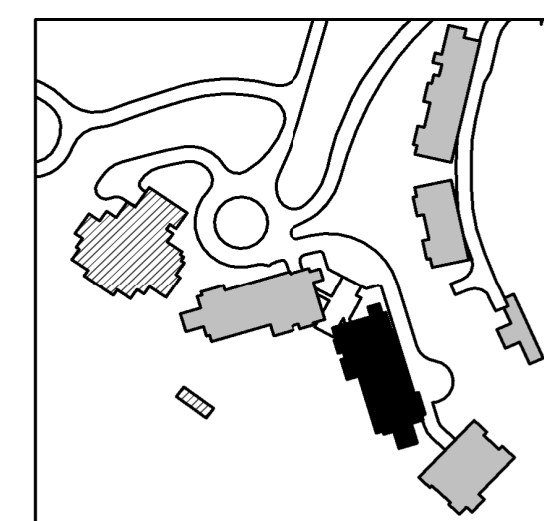

1 TOWER B - PARKING LEVEL 2 ELECTRICAL LIGHTING RCP
SCALE: 1/8" = 1'-0"