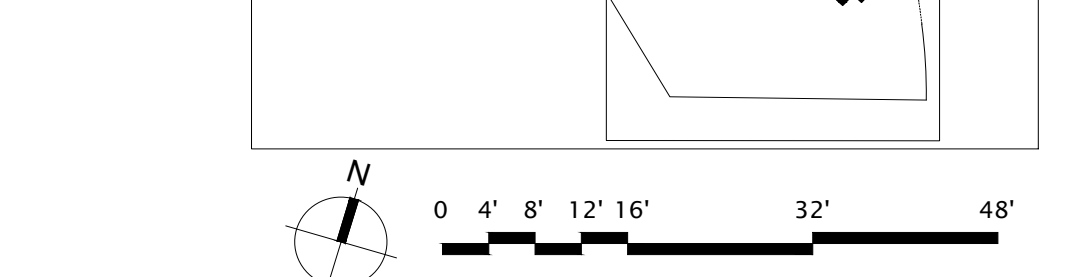
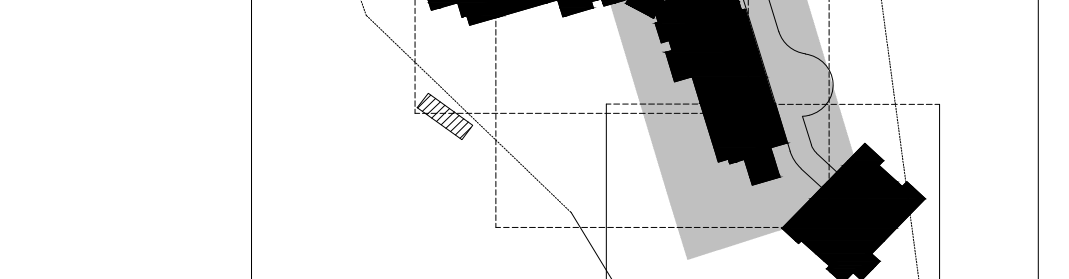
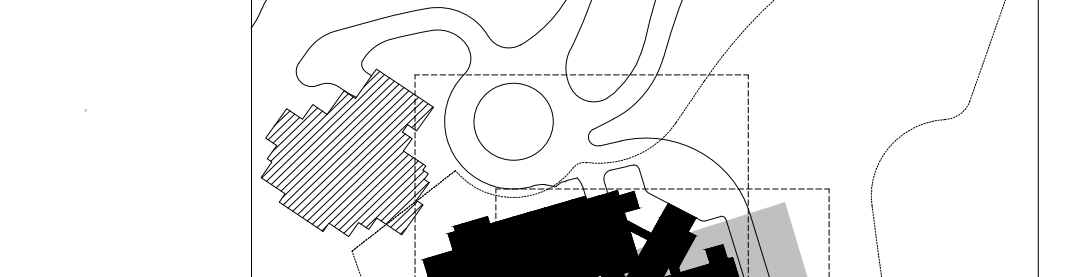
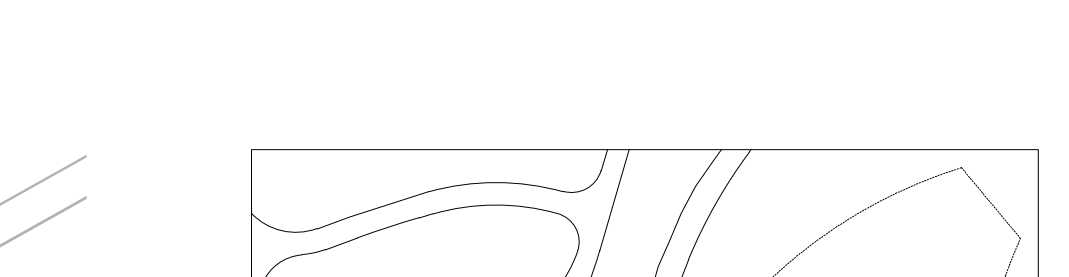
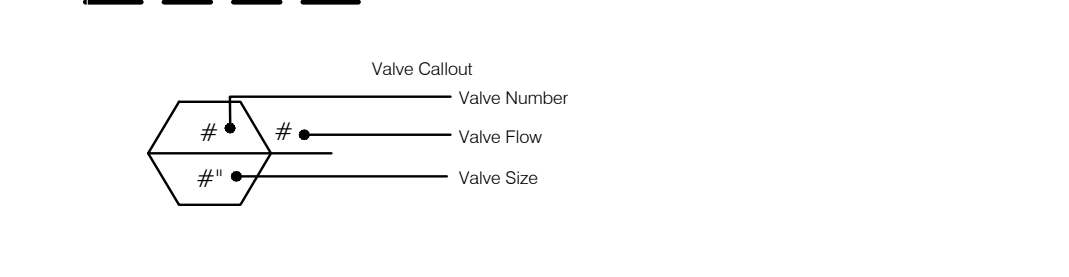

[illegible]

1" = 10'-0"

**DISCLAIMER:**

THE DESIGNS SHOWN AND DESCRIBED HEREIN (INCLUDING ALL TECHNICAL DRAWINGS, GRAPHIC REPRESENTATIONS, AND MODELS) THEREOF ARE PROPRIETARY AND CAN NOT BE COPIED, Duplicated, OR COMMERCIALLY EXPLOITED IN WHOLE OR IN PART WITHOUT THE SOLE AND EXPRESS WRITTEN PERMISSION FROM ENVIRONMENTAL PLANNING GROUP (EPG).

ENVIRONMENTAL PLANNING GROUP (EPG) PROVIDED QUANTITIES ARE CALCULATED BASED ON THE 3D MODEL, PROGRAM, CONTRACTORS ARE RESPONSIBLE FOR REVIEWING THE SECTION AND PROVIDING THEIR OWN CALCULATIONS AND AREAS FOR THE PURPOSES OF COST ESTIMATING / BIDDING.

THE CLIENT AND/OR THE CLIENT'S CONTRACTOR, IS RESPONSIBLE FOR ATTAINING OR PROVIDING THE NECESSARY CONTRACTOR PERMIT FOR CITY CODE COMPLIANCE.

**Olson Kundig**  
159 South Jackson St., Suite 600  
Seattle, Washington 98104 USA  
+1 206 464 5970 [www.olsonkundig.com](http://www.olsonkundig.com)

**SOMMET BLANC RESIDENCE 1**  
ADDRESS  
PARK CITY, UT

**White Summit Development, LLC**  
PO Box 980022  
Park City, Utah 84098

Acoustic Consultant  
**BRC Acoustics**  
1932 1st Ave, Suite 620  
Seattle, WA 98101

**Pool Consultant**  
**Cloward H2O**  
2696 N University Ave, Suite 290  
Provo, UT 84604

8949 South High Tech Drive, Suite 100  
Midvale, Utah 84047

Specifications Writer  
Friday Group  
88 Mainelli Road  
Middlebury, VT

**Code Consultant**  
**Holmes**  
600 1st Avenue, Suite 200A  
Seattle, WA 98104

Fire Protection Engineer  
**Jensen Hughes**  
One Research Drive, Suite 305C  
Westborough, MA 01581

**Vertical Transportation Consultant**  
**Lerch Bates**  
19515 North Creek Parkway, Suite 304  
Bothell, WA 98011

Structural Engineer  
**Magnusson Klemencic Associates**  
1301 5th Ave, Suite 3200  
Seattle, WA 98101

**Lighting Designer**  
O-  
1319 SE MLK Blvd, Suite 210  
Portland, Oregon 97219

**Building Envelope Consultants**  
**RDH**  
2101 N 34th St  
Seattle, WA 98103

**Accessibility Consultant**  
**Studio Pacifica**  
2144 Westlake Ave N, Suite F  
Seattle, WA 98109

**MEP Engineer**  
**WSP USA**  
1001 Fourth Ave., Suite 3100  
Seattle, WA 98154

Grant Hardy  
Grant Hardy

Checker  
20052  
May 17, 2020

 IFC 2.5/17/2024

CONSTRUCTION  
DOCUMENTS 95%  
IFC SET 2 OF 3  
May 17, 2024