

A. CONFIRM EXACT LOCATION OF ALL WALL DEVICES WITH ARCHITECTURAL ELEVATIONS.
B. CONFIRM ALL CEILING AND WALL ACCESS DOORS WITH ARCHITECTURAL R/GPS AND WALL ELEVATIONS.
C. REFER TO M3-2A-01 THROUGH M3-2C-R FOR RADIANT FLOOR H/W/S/R PIPING ROUTING AND SIZING.
D. PROVIDE 1-INCH ACCESS LINING FOR ENTRY/EXIT OF MAIN DUCT RUN OFF FAN COIL.
E. ALL RESIDENTIAL TOILET EXHAUST, DRYER EXHAUST, AND KITCHEN RANGE HOOD EXHAUST TO BE PART OF A SUB-DUCT EXHAUST SYSTEM.
F. ROUTE 3/4" CONDENSATE DRAINS FROM FCUS TO NEAREST SINK TAILPIECE.

2 RANGE HOOD EXHAUST FAN TO BE INTEGRAL WITH RANGER SPECIFIED BY THE ARCHITECT. INTERLOCK CONTROL WITH MUA-A
ELECTRICAL RADIANT FLOOR TO BE PROVIDED IN MASTER BATHROOM. SEE ELECTRICAL DRAWINGS.

3 OWNER OPTION: PROVIDE 208(16A)1 CONNECTION FOR APRILAIRE 800 HUMIDIFIER DOWNSTREAM OF FAN COIL UNIT. REFER TO
ELECTRICAL DRAWINGS FOR DETAIL. REFER TO PLUMBING DRAWINGS FOR 1/2" CW CONNECTION. ROUTE 3/4" CD TO NEAREST
SINK TAILPIPE. REFER TO DETAILS M5.0418 & M5.0412 FOR INSTALLATION CONNECTION.

63	125	250	500	1000	2000	4000	8000
0	4	6	8	7	9	8	0

CONFIRM WITH OWNER AND ARCHITECT PRIOR TO PROVIDING HUMIDIFIER.

- OWNER OPTION: PROVIDE 120(16A)/1 CONNECTION FOR APRILAIRE 800 HUMIDIFIER DOWNSTREAM OF FAN COIL UNIT. REFER TO ELECTRICAL DRAWINGS FOR DETAIL. REFER TO PLUMBING DRAWINGS FOR 1/2" CW CONNECTION. ROUTE 3/4" CD TO NEAREST SINK TAILPIECE. REFER TO DETAILS M5.04/8 & M5.04/12 FOR INSTALLATION CONNECTION.

63	125	250	500	1000	2000	4000	8000
0	4	6	8	7	9	8	0

REMOVE SOUND LINING FROM FCU AND PROVIDE PRICE RSP 3'-0" SOUND ATTENUATOR WITH A MINIMUM INSERTION LOSS OF:

- CONFIRM WITH OWNER AND ARCHITECT PRIOR TO PROVIDING HUMIDIFIER.
6 CONNECT 4"Ø TO DRYER.
7 LOCATION OF STEAM GENERATOR FOR DUCT HUMIDIFIER. CONFIRM EXACT LOCATION WITH ARCHITECT PRIOR TO INSTALLING.

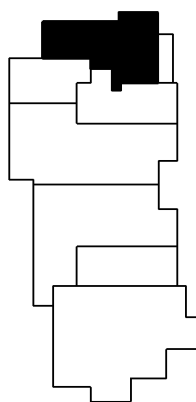

1 TOWER A/B - MECHANICAL PLAN - UNIT P
SCALE: 1/4" = 1'-0"

0 1' 2' 3' 4' 8' 12

Reserved for permit stamp

159 South Jackson St, Suite 600
Seattle, Washington 98104 USA
+1 206 624 5670 olsonkunding.com

Olson Kundig

project:
SOMMET BLANC
9300 Marsac Ave (B2 East Parcel)
Park City, Utah 84060

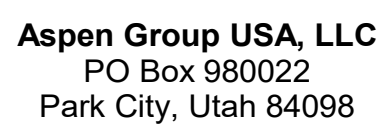

Pool Consultant
Cloward H2O
2696 N University Ave, Suite 290
Provo, UT 84604

Landscape Architect
EPG Design
6949 South High Tech Drive, Suite 100
Midvale, Utah 84047

Specifications Writer
Friday Group
88 Mainelli Road
Middlebury, VT

Code Consultant
Holmes
600 1st Avenue, Suite 200A
Seattle, WA 98104

Fire Protection Engineer
Jensen Hughes
One Research Drive, Suite 305C
Westborough, MA 01581

Vertical Transportation Consultant
Lerch Bates
19515 North Creek Parkway, Suite 304
Bothell, WA 98011

Structural Engineer
Magnusson Klemencic Associates
1301 5th Ave, Suite 3200
Seattle, WA 98101

Lighting Designer
O*
1319 SE MLK Blvd, Suite 210
Portland, Oregon 97219

Building Envelope Consultant
RDH
2101 N 34th St
Seattle, WA 98103

Accessibility Consultant
Studio Pacifica
2144 Westlake Ave N, Suite F
Seattle, WA 98109

MEP Engineer
WSP USA
1001 Fourth Ave., Suite 3100
Seattle, WA 98154

principal architect _____
project manager _____
drawn by _____
checked by Checker
job no. _____
date 5/31/2024

revisions:

no.	date	by
-----	------	----

IFC Set 3 of 3
5/31/2024

ENLARGED
MECHANICAL DUCT
PLAN - UNIT P

M2.4.P