

SPACING IS LESS THAN 12 INCHES.

ANCHORS HORIZONTALLY FOR SLABS LESS THAN 7 INCHES THICK

## DISTRIBUTED TENDONS

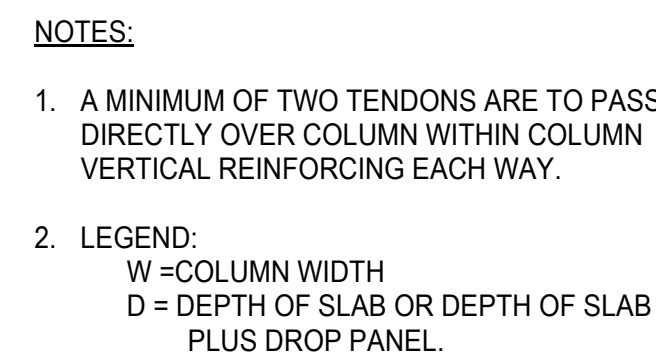

### REINFORCING AT INTERIOR SUPPORT

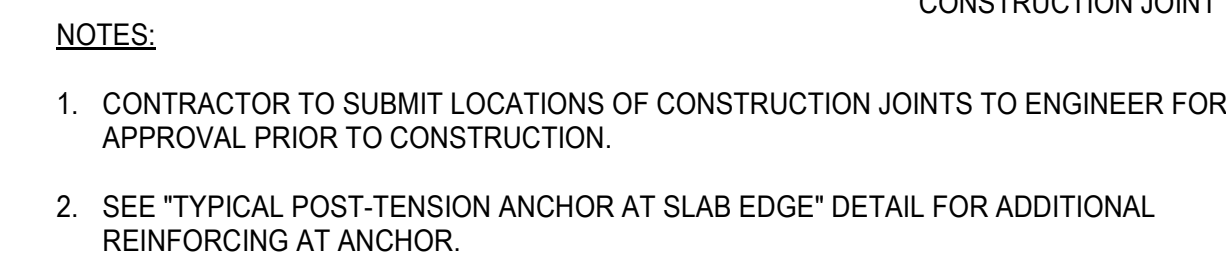

NOTES:

1. ACCEPTABLE FOR BAR PROVIDED ON PLAN TO SATISFY NOTED REINFORCEMENT REQUIREMENTS.

**NOTES:**

1. SEE "TYPICAL POST-TENSION ANCHOR AT SLAB EDGE" DETAIL FOR ADDITIONAL REINFORCING AT ANCHOR.
2. SHORE SLAB UNTIL DELAY STRIP HAS REACHED 28 DAY DESIGN STRENGTH.
3. LAP SPlice Lsb UNLESS NOTED OTHERWISE. WHERE LAP CANNOT BE ACHIEVED, PROVIDE BAR COUPLERS THAT REMAIN UNFASTENED UNTIL JUST PRIOR TO CASTING OF CLOSURE STRIP.

NOTES:

1. SEE "TYPICAL MILD SLAB STEP REINFORCING" FOR REINFORCEMENT AT STEP NOT SHOWN HERE.

18 TYPICAL PT WIDE SHALLOW

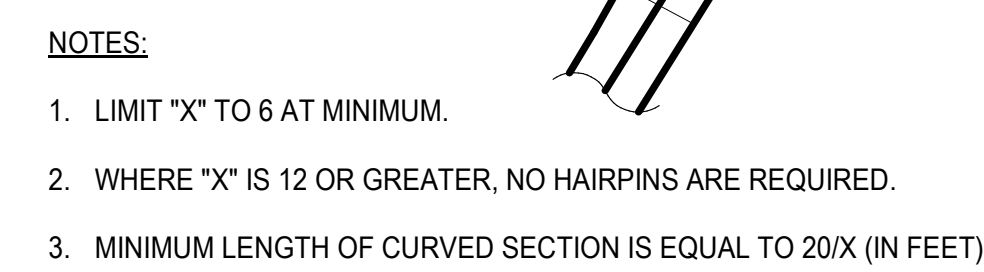

NOTES:

1. SLAB SHEAR REINFORCING NOT SHOWN

SECTION B



S4.05