

SOMMET BLANC

Location: 9300 Marsac Avenue (B2 East Parcel), Park City, Utah  
Project Number: 20052

LD-10

IFC Issuance: 07/19/2024

Product Info

Manufacturer: TBD  
Style/Series: CUSTOM CHANDELIER

Attributes

Location : A/B Lobby  
Finish/Color :  
Dimensions: 15'-6" Dia. x 4'-0"H  
Color Temperature : 2700K  
Wattage: TBD

Notes

To be developed with fabricator

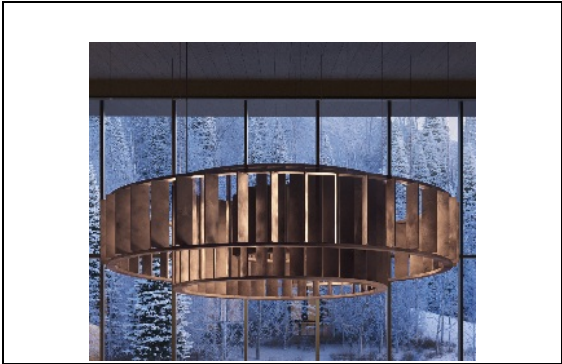

• Provide Manufacturer's warranty information  
• Provide manufacturer's assembly instructions including a list pf parts included in all shipments.  
• Olson Kundig owns all copyrights to the design of custom products. Photography of product is prohibited without the expressed written consent by Olson Kundig.  
• All drawings provided are for reference only, and not for construction

Seattle, Washington