

PLANT SCHEDULE			
SYMBOL	QTY	COMMON / BOTANICAL NAME	SIZE
TREES			
	11	AMUR MAPLE	2" CAL
	1	ACER GINNALA	12" HT
	22	COLORADO SPRUCE PICEA PUNGENS	8" HT
	6	DOWNY SERVICEBERRY AMELANCHIER ARBOREA TREES TO BE CUSTOM PICKED BY LANDSCAPE ARCHITECT AT SOURCE.	2.5" CAL
	72	QUAKING ASPEN POPULUS TREMULOIDES	1" CAL
	189	QUAKING ASPEN POPULUS TREMULOIDES	2" CAL
	19	QUAKING ASPEN POPULUS TREMULOIDES	3" CAL
	19	TATARIAN MAPLE ACER TATARICUM	2" CAL
SHRUBS			
	37	BURNING BUSH EUCONYMUS ALATUS	5 GAL
	482	DENSE ANGLO-JAPANESE YEW TAXUS X MEDIA 'DENSIFORMIS'	5 GAL
	836	EMERALD CARPET MANZANITA ARCTOSTAPHYLOS X 'EMERALD CARPET'	5 GAL
	835	LITTLE BLUESTEM SCHIZACHYRIUM SCOPARIUM	1 GAL
	89	MOUNTAIN SNOWBERRY SYMPHORICARPOS OREOPHILUS	5 GAL
	282	OREGON GRAPE BERBERIS AQUIFOLIUM	1 GAL
	55	PROSTRATE PLUM YEW CEPHALOTAXUS HARRINGTONIA 'PROSTRATA'	5 GAL
EMPIRE PASS			
	127	ALPINE CURRANT RIBES ALPINUM	1 GAL
	26	COMMON WHITE SNOWBERRY SYMPHORICARPOS ALBUS	5 GAL
	6	PAWNEE BUTTES SAND CHERRY PRUNUS BESSEYI 'P011S' TM	5 GAL
EMPIRE PASS PERENNIAL AND GROUND COVER			
	969	CREeping MAHONIA MAHONIA REPENS	1 GAL
	378	SWEET WOODRUFF GALIUM ODORATUM	1 GAL
GROUND COVERS			
	37,282 SF	BIONATIVE SOD NOTES: 1. ROCKY MOUNTAIN WILDFLOWER SEED MIX OVERSEEDDED INTO BIO NATIVE SOD AFTER SOD INSTALLATION.	SOD
	6,800 SF	KENTUCKY BLUEGRASS POA PRATENSIS SKI BEACH - LENGTH MUST BE KEPT BELOW 4" BIONATIVE SOD NOTES: 1. OWNER MUST TO MOW THIS AREA TO KEEP LENGTH BELOW 4" 2. ROCKY MOUNTAIN WILDFLOWER SEED MIX OVERSEEDDED INTO BIO NATIVE SOD AFTER SOD INSTALLATION.	SOD
	1,244 SF		SOD

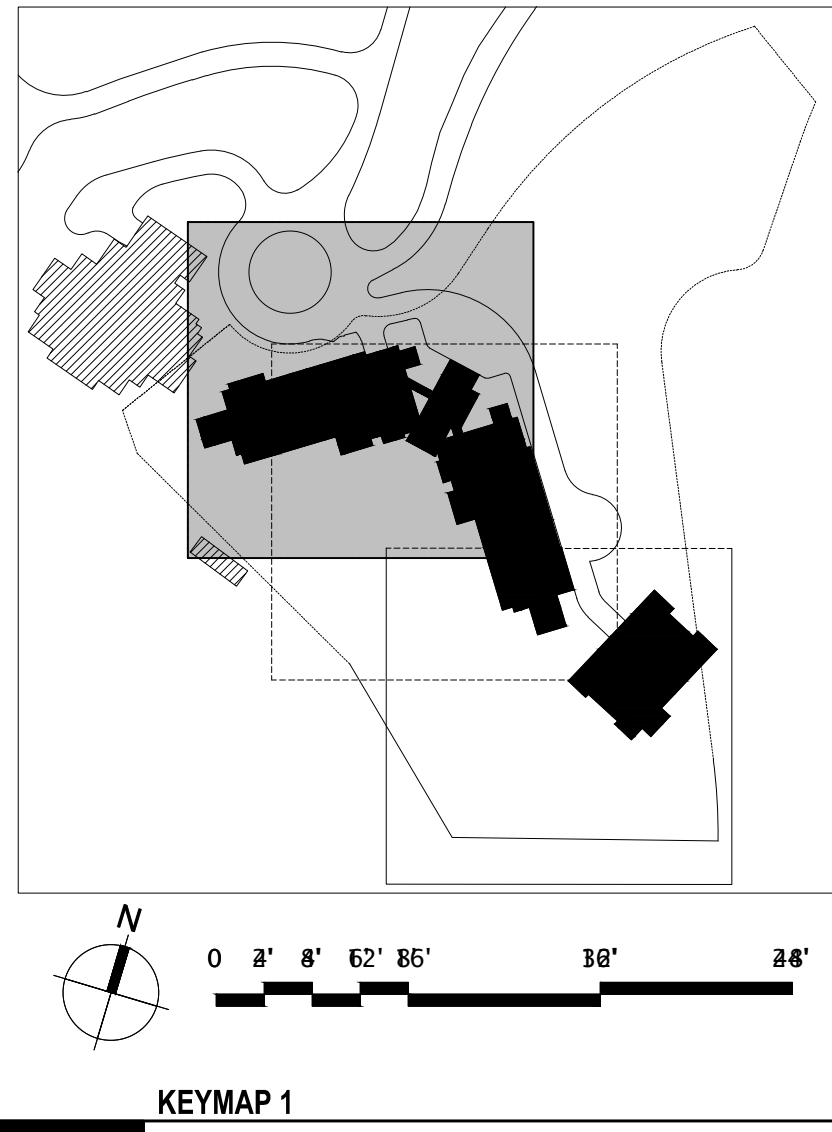

DISCLAIMER:
THE DESIGN SHOWN AND DESCRIBED HEREIN INCLUDING ALL TECHNICAL DRAWINGS, GRAPHIC REPRESENTATIONS, AND MODELS THEREOF ARE PROPRIETARY AND CAN NOT BE COPIED, DUPLICATED, OR COMMERCIALLY EXPLOITED OR IN ANY MANNER WITHOUT THE WRITTEN AND EXPRESS WRITTEN PERMISSION FROM ENVIRONMENTAL PLANNING GROUP (EPG).
ENVIRONMENTAL PLANNING GROUP (EPG) PROVIDED QUANTITIES ARE CALCULATED BASED ON THE 3D MODEL PROVIDED. CONTRACTORS ARE RESPONSIBLE FOR REVIEWING THE DESIGN AND PROVIDING THEIR OWN CALCULATIONS AND AREAS FOR THE PURPOSES OF COST ESTIMATING RECORDS.
THE CLIENT AND/OR THE CLIENT'S CONTRACTOR IS RESPONSIBLE FOR OBTAINING OR PROVIDING THE NECESSARY CONSTRUCTION PERMIT FOR CITY CODE COMPLIANCE.

8/2/2024

Reserved for permit stamp

199 South Jackson St, Suite 600
Salt Lake City, UT 84143
Tel: 313.004.0000
www.olsonkundig.com

Olson Kundig

project
SOMMET BLANC RESIDENCE 1
ADDRESS
PARK CITY, UT

White Summit Development, LLC
PO Box 980022
Park City, Utah 84098

Acoustic Consultant
BRC Acoustics
1932 1st Ave, Suite 620
Seattle, WA 98101

Pool Consultant
Howard H2O
2696 N University Ave, Suite 290
Provo, UT 84604

Landscape Architect
EPG Design
6948 South High Tech Drive, Suite 100
Midvale, Utah 84047

Specifications Writer
Friday Group
88 Mainelli Road
Nashbury, VT

Code Consultant
Holmes
600 1st Avenue, Suite 200A
Seattle, WA 98104

Fire Protection Engineer
Jensen Hughes
One Research Drive, Suite 305C
Westborough, MA 01581

Vertical Transportation Consultant
Lorch Bates
15515 North Creek Parkway, Suite 304
Bothell, WA 98011

Structural Engineer
Magnusson Klemencic Associates
1301 5th Ave, Suite 3200
Seattle, WA 98101

Lighting Designer
Q
1319 SE MLK Blvd, Suite 210
Portland, Oregon 97219

Building Envelope Consultant
RDH
2101 N 34th St
Seattle, WA 98103

Accessibility Consultant
WSP USA
1001 Fourth Ave, Suite 3100
Seattle, WA 98154

MEP Engineer
WSP USA
1001 Fourth Ave, Suite 3100
Seattle, WA 98154

principal architect...David Harris
project manager...Grant Hardy
drawn by...Grant Hardy

checked by...Michael Park
job no. 20952
date June 10, 2024

revisions:
IFC 2 5/17/2024
VLU Updates 7/29/2024

no. date by

PERMIT SET
IFC SET 2 OF 3

June 10, 2024

PLANTING PLAN

L501