

PLANT SCHEDULE			
SYMBOL	QTY	COMMON / BOTANICAL NAME	SIZE
TREES			
	11	AMUR MAPLE	2" CAL
	1	ACER GINNALA	
	22	COLORADO SPRUCE PICEA PUNGENS	12' HT
	6	COLORADO SPRUCE PICEA PUNGENS	8' HT
	72	DOWNY SERVICEBERRY AMELANCHIER ARBOREA TREES TO BE CUSTOM PICKED BY LANDSCAPE ARCHITECT AT SOURCE.	2.5" CAL
	189	QUAKING ASPEN POPULUS TREMULOIDES	1" CAL
	19	QUAKING ASPEN POPULUS TREMULOIDES	2" CAL
	19	QUAKING ASPEN POPULUS TREMULOIDES	3" CAL
	19	TATARIAN MAPLE ACER TATARICUM	2" CAL
SHRUBS			
	37	BURNING BUSH EUCONYMUS ALATUS	5 GAL
	482	DENSE ANGLO-JAPANESE YEW TAXUS X MEDIA 'DENSIFORMIS'	5 GAL
	836	EMERALD CARPET MANZANITA ARCTOSTAPHYLOS X 'EMERALD CARPET'	5 GAL
	835	LITTLE BLUESTEM SCHIZACHYRIUM SCOPARIUM	1 GAL
	89	MOUNTAIN SNOWBERRY SYMPHORICARPOS OREOPHILUS	5 GAL
	262	OREGON GRAPE BERBERIS AQUIFOLIUM	1 GAL
	55	PROSTRATE PLUM YEW CEPHALOTAXUS HARRINGTONIA 'PROSTRATA'	5 GAL
EMPIRE PASS			
	127	ALPINE CURRANT RIBES ALPINUM	1 GAL
	26	COMMON WHITE SNOWBERRY SYMPHORICARPOS ALBUS	5 GAL
	6	PAWNEE BUTTES SAND CHERRY PRUNUS BESSEYI 'P011S' TM	5 GAL
EMPIRE PASS PERENNIAL AND GROUND COVER			
	969	OREGON GRAPE BERBERIS AQUIFOLIUM	1 GAL
	378	SWEET WOODRUFF GALIUM ODORATUM	1 GAL
GROUND COVERS			
	37,282 SF	BIONATIVE SOD NOTES: 1. ROCKY MOUNTAIN WILDFLOWER SEED MIX OVERSEEDDED INTO BIO NATIVE SOD AFTER SOD INSTALLATION.	SOD
	6,800 SF	KENTUCKY BLUEGRASS POA PRATENSIS SKI BEACH - LENGTH MUST BE KEPT BELOW 4" BIONATIVE SOD NOTES: 1. OWNER MUST TO MOW THIS AREA TO KEEP LENGTH BELOW 4" 2. ROCKY MOUNTAIN WILDFLOWER SEED MIX OVERSEEDDED INTO BIO NATIVE SOD AFTER SOD INSTALLATION.	SOD
	1,244 SF		SOD

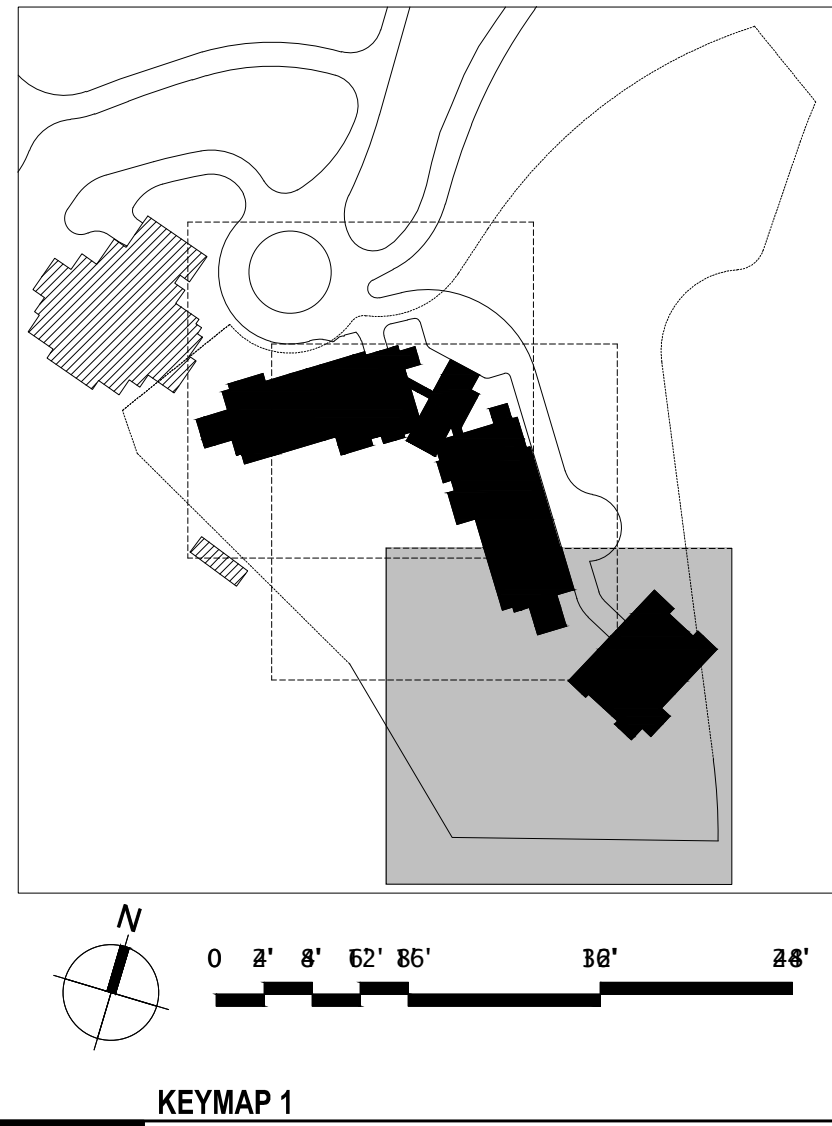

DISCLAIMER:  
THE DESIGN SHOWN AND DESCRIBED HEREIN INCLUDING ALL TECHNICAL DRAWINGS, GRAPHIC REPRESENTATIONS, AND MODELS THEREOF ARE PROPRIETARY AND CAN NOT BE COPIED, REPRODUCED, OR COMMERCIALY EXPLOITED IN ANY MANNER WITHOUT THE WRITTEN AND EXPRESS WRITTEN PERMISSION FROM ENVIRONMENTAL PLANNING GROUP GROUP (EPG).  
ENVIRONMENTAL PLANNING GROUP GROUP (EPG) PROVIDED QUANTITIES ARE CALCULATED BASED ON THE 3D MODEL PROVIDED. CONTRACTORS ARE RESPONSIBLE FOR REVIEWING THE DESIGN AND PROVIDING THEIR OWN CALCULATIONS AND AREAS FOR THE PURPOSES OF COST ESTIMATING. RECORD.  
THE CLIENT, AND/OR THE CLIENT'S CONTRACTOR, IS RESPONSIBLE FOR OBTAINING OR PROVIDING THE NECESSARY CONSTRUCTION PERMIT FOR CITY CODE COMPLIANCE.

8/2/2024

Reserved for permit stamp

199 South Jackson St., Suite 200  
Salt Lake City, Utah 84114 USA  
+1 360 454 1070  
olsonkunding.com

**Olson Kundig**

project  
**SOMMET BLANC RESIDENCE 1**  
ADDRESS  
PARK CITY, UT

**White Summit Development, LLC**  
PO Box 980022  
Park City, Utah 84098

**Acoustic Consultant**  
**BRC Acoustics**  
1932 1st Ave., Suite 620  
Seattle, WA 98101

**Pool Consultant**  
**Cloward 100**  
2696 N University Ave., Suite 290  
Provo, UT 84604

**Landscape Architect**  
**EPG Design**  
6946 South High Tech Drive, Suite 100  
Midvale, Utah 84047

**Specifications Writer**  
**Friday Group**  
88 Mainelli Road  
Middletown, VT

**Code Consultant**  
**Holmes**  
600 1st Avenue, Suite 200A  
Seattle, WA 98104

**Fire Protection Engineer**  
**Jensen Hughes**  
One Research Drive, Suite 305C  
Westborough, MA 01581

**Vertical Transportation Consultant**  
**Larch Bates**  
15515 North Creek Parkway, Suite 304  
Bothell, WA 98011

**Structural Engineer**  
**Magnusson Klemencic Associates**  
1301 5th Ave., Suite 3200  
Seattle, WA 98101

**Lighting Designer**  
**Q**  
1319 SE MLK Blvd., Suite 210  
Portland, Oregon 97219

**Building Envelope Consultant**  
**RDH**  
2101 N 34th St  
Seattle, WA 98103

**Accessibility Consultant**  
**Studio Pacifica**  
2144 Westlake Ave N, Suite F  
Seattle, WA 98109

**MEP Engineer**  
**WSP USA**  
1001 Fourth Ave., Suite 3100  
Seattle, WA 98154

principal architect...David Harris  
project manager...Grant Hardy  
drawn by...Grant Hardy  
checked by...Michael Park  
job no. 20952  
date June 10, 2024

revisions:  
IFC 2 5/17/2024  
VLU Updates 7/29/2024

no. date by

**PERMIT SET**  
IFC SET 2 OF 3  
June 10, 2024

**PLANTING PLAN**  
**L503**