

159 South Jackson St, Suite 800
Seattle, Washington 98104 USA
+1 206 624 5670 disontkundig.com

Olson Kundig

project: **SOMMET BLANC**
9300 Marsac Ave (B2 East Parcel)

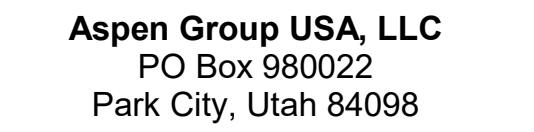

Edward H20
6 N University Ave, Suite 290
Provo, UT 84604

dscape Architects
G Design
 9 South High Tech Drive, Suite 10
 Vale, Utah 84047

Day Group
Mainelli Road
Dalebury, VT

Life Consultant
James
1st Avenue, Suite 200A
Seattle, WA 98104

Protection Engineer
Ken Hughes
Research Drive, Suite 305C
Westborough, MA 01581

Technical Transportation Consultant
Rich Bates
15 North Creek Parkway, Suite 300
Bellevue, WA 98011

Structural Engineer
Ingusson Klemencic Associates
1151 5th Ave, Suite 3200
Seattle, WA 98101

9 SE MLK Blvd, Suite 210
Tualatin, Oregon 97219

ding Envelope Consultant
H
1 N 34th St
attle, WA 98103

Accessibility Consultant
Radio Pacifica
4 Westlake Ave N, Suite F
Seattle, WA 98109

P Engineer
P USA
11 Fourth Ave., Suite 3100
Seattle, WA 98154

principal architect _____
project manager _____
drawn by _____
checked by Checker _____
job no. _____
date 5/31/2024

ions:

5/2/2025	ASI-011 - WSP
01/17/2025	ASI 008

date	by
------	----

C Set 3 of 3

5/31/2024

POWER B - LVL B
ELECTRICAL LIGHTING
PLAN

E3.2B.01

SHEET NOTES:

- [illegible]

NUMBERED NOTES:

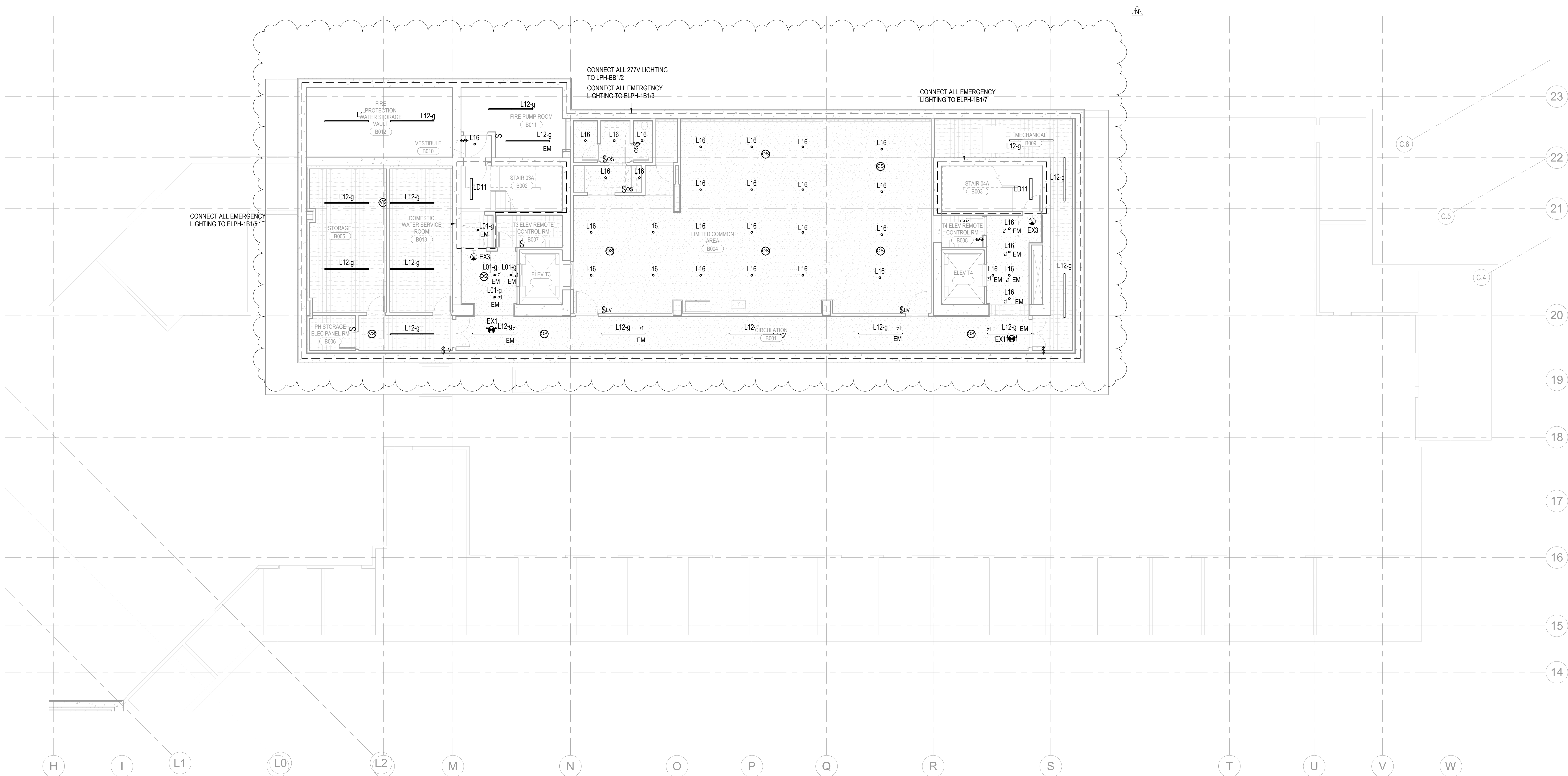

1 TOWER B LEVEL B1 ELECTRICAL LIGHTING RCP
SCALE: 1/8" = 1'-0"

