

159 South Jackson St, Suite 800
Seattle, Washington 98104 USA
1 206 624 5670 olsonkundig.com

Olson Kundig

Project: **SOMMET BLANC**
3300 Marsac Ave (B2 East Parcel)

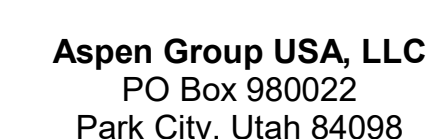

principal architect _____
project manager _____
drawn by _____
checked by Checker
job no. _____
date 05/31/2024

[illegible]

IFC Set 3 of 3
05/31/2024

TOWER C ELECTRICAL
LIGHTING PLAN - UNIT N

E3.4.N

DRAWINGS ARE INTENDED TO SHOW GENERAL ARRANGEMENT, DESIGN, AND EXTENT OF WORK AND ARE DIAGNOSTIC. DRAWINGS ARE NOT INTENDED TO SHOW EXACT LOCATIONS EXCEPT WHERE DIMENSIONS ARE SHOWN. ELECTRICAL WORK IS SHOWN ON PLANS USING THE CONVENTIONAL SYMBOLS AND NOTATION OF THE NATIONAL ELECTRICAL CODE. VERIFY MEASUREMENTS PERTAINING THERETO AND ASSUME RESPONSIBILITY THEREFOR. ANY SUBSTANTIAL DIFFERENCES BETWEEN DRAWINGS AND CONDITIONS IN THE FIELD ARE TO BE SUBMITTED TO THE ARCHITECT FOR REVIEW AND APPROVAL PRIOR TO PROCEEDING WITH WORK.

THE CONTRACTOR SHALL PROVIDE THE NECESSARY LABOR, MATERIALS, AND EQUIPMENT REQUIRED TO INSTALL A COMPLETE ELECTRICAL SYSTEM AS INDICATED ON DRAWINGS AND SPECIFICATIONS. PROVIDE EXISTING SIGNS AND CONNECTION EXIST SIGNS AND LUMINAIES NOTED AS EMERGENCY TO REMAIN TO COVER SPACES TO BE REMOVED. PROVIDE EXISTING SIGNS AND LUMINAIES TO REMAIN TO COVER SPACES TO BE REMOVED. REFER TO LUMINAIE SCHEDULE FOR INFORMATION.

VERIFY FUTURE CALL NUMBERS ARE SUBJECT TO CHANGE BY MANUFACTURER. VERIFY FUTURE CALL NUMBERS FOR EQUIPMENT ARE SUBJECT TO CHANGE BY MANUFACTURER.

VERIFY EQUIPMENT SIZES AND POWER REQUIREMENTS FOR EQUIPMENT PROVIDED BY OTHERS.

ELECTRICAL CONDITIONS IN FINISHED SPACES SHALL BE CONCEALED. COORDINATE WITH OTHER TRADES AND USE CHASES AND CEILING SPACES. LOCATIONS OF ELECTRICAL JUNCTION BOXES IN FINISHED SPACES SHALL BE APPROVED BY ARCHITECT PRIOR TO ROUGH IN.

COORDINATE REMOTE VOLTAGE MOUNTING LOCATIONS WITH ARCHITECT PRIOR TO ROUGH IN.

COORDINATE REMOTE VOLTAGE WITH ARCHITECT AND OWNER PRIOR TO PURCHASE AND INSTALLATION.

- 1 LUTRON WIRELESS PICO CONTROL SWITCH IS TO BE SUPPLIED AND INSTALLED FOR SHADE CONTROL.
- 2 LIGHT FIXTURE LOCATION IN CLOSETS ARE TO BE CONTROLLED BY CLOSET DOOR JAM SWITCH.
- 3 SUPPLY AND INSTALL LUTRON RADIO RAS2 SYSTEM TO PROVIDE PARTIAL LIGHTING CONTROL IN THE RESIDENTIAL UNITS. MASTER BEDROOM (DENOTED AS BED 1) AND ALL ROOMS WITH MORE THAN THREE (3) LIGHTING CONTROL ZONES ARE TO BE UTILIZED FOR LIGHTING CONTROL. BATHS, BEDROOMS WITH THREE (3) LIGHTING CONTROL ZONES OR LESS ARE TO BE CONTROLLED BY LOCAL DIMMERS.
- 4 REFER TO ARCHITECTURAL DRAWINGS AND ELEVATIONS FOR EXACT DIMENSION AND MOUNTING LOCATION OF LIGHT FIXTURE TYPE L40. COORDINATE WITH MILLWORK CONTRACTOR PRIOR TO INSTALLATION.
- 5 SUPPLY AND INSTALL MOUNTING HARDWARE FOR EACH LIGHT FIXTURE COMPLETE WITH CAPPED LIGHTING CIRCUIT WIRING FOR INSTALLATION OF FUTURE LABEL LIGHT FIXTURES.

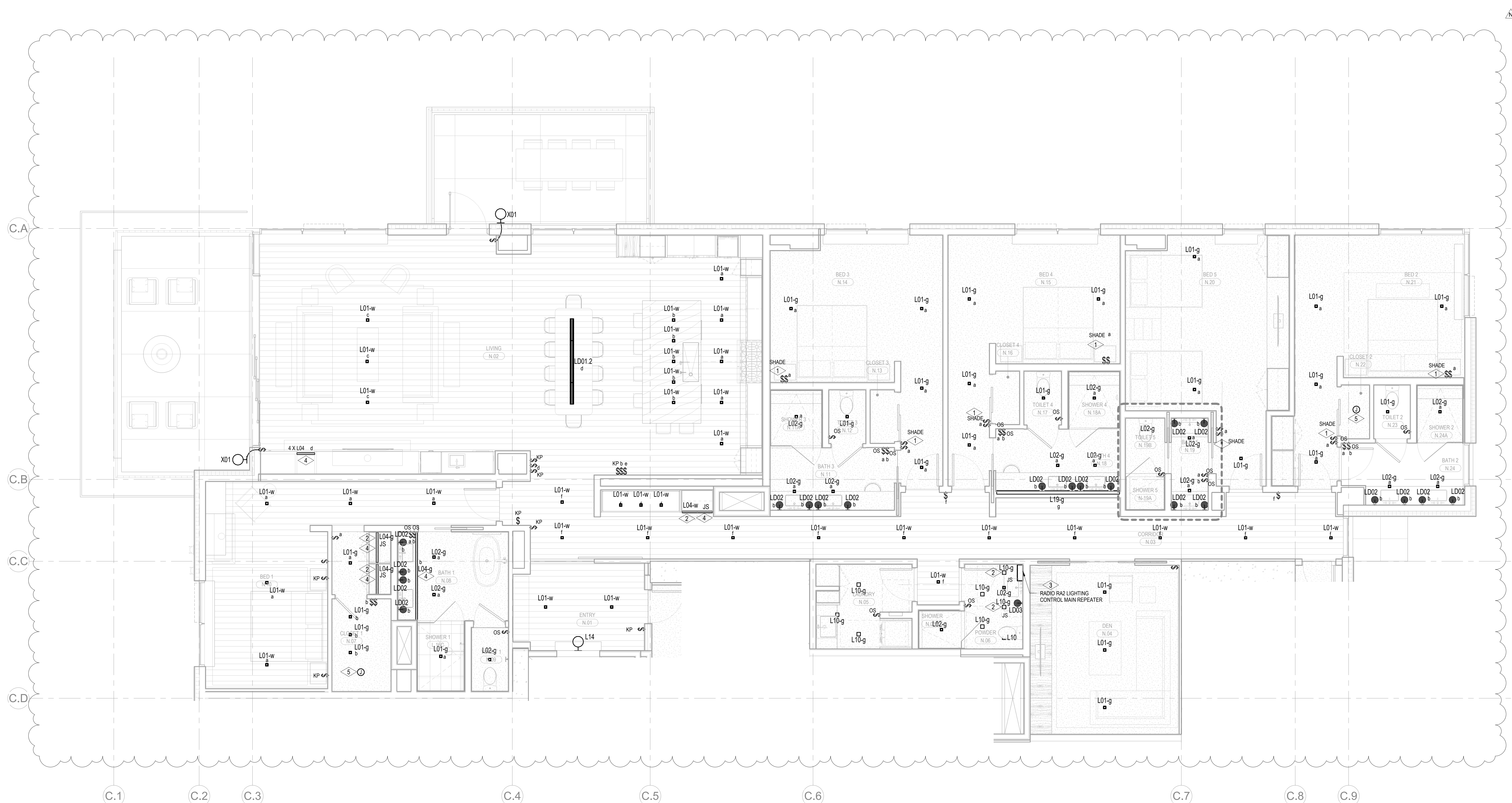

1 TOWER C - ELECTRICAL LIGHTING UNIT PLAN - N
SCALE: 1/4" = 1'-0"

