

- KEYNOTES:

 - 1 FIRE ALARM TERMINAL CABINET WITHIN 2-HR RATED SHAFT ACCESSIBLE VIA 2-HR RATED ACCESS PANEL. COORDINATE INSTALLATION AND ACCESS WITH DIVISION 26. TRANSITION FROM 2-HR CIC TO FPL CABLE IN EMT AT THIS POINT.
 - 2 2-HR CIC SLC AND NAC FROM FCC TO 2-HR RATED SHAFT. ROUTING SHOWN FOR CONCEPTUAL PURPOSES ONLY.
 - 3 DEDICATED SPEAKER CIRCUIT (2-HR CIC) TO STAIR SPEAKERS. TRANSITION TO FPL IN EMT AT FIRST DEVICE.



Reserved for permit stamp

159 South Jackson St, Suite 800
Seattle, Washington 98104 USA
+1 206 624 5670 osorkundig.com

Olson Kundig

project: **SOMMET BLANC - AB**
DEER VALLEY, UTAH



Aspen Group USA, LLC
PO Box 980022
Park City, Utah 84098

Pool Consultant
Cloward H2O
2696 N University Ave, Suite 290
Provo, UT 84604

Landscape Architect
EPG Design
6949 South High Tech Drive, Suite 100
Midvale, Utah 84047

Specifications Writer
Friday Group
88 Mainelli Road
Middlebury, VT

Code Consultant
Holmes
600 1st Avenue, Suite 200A
Seattle, WA 98104

Fire Protection Engineer
Jensen Hughes
One Research Drive, Suite 305C
Westborough, MA 01581

Vertical Transportation Consultant
Lerch Bates
19515 North Creek Parkway, Suite 304
Bothell, WA 98011

Structural Engineer
Magnusson Klemencic Associates
1301 5th Ave, Suite 3200
Seattle, WA 98101

Lighting Designer
O-
1319 SE MLK Blvd, Suite 210
Portland, Oregon 97219

Building Envelope Consultant
RDH
2101 N 34th St
Seattle, WA 98103

Accessibility Consultant
Studio Pacifica
2144 Westlake Ave N, Suite F
Seattle, WA 98109

MEP Engineer
WSP USA
1001 Fourth Ave., Suite 3100
Seattle, WA 98154

principal architect _____
project manager JCC _____
drawn by CRB, SMK _____
checked by Checker _____
job no. 20052
date 05/17/2024

[illegible]

no.	date	by
-----	------	----

IFC Set 2 of 3
05/17/2024

FIRE ALARM PLAN -
TOWER B - LVL P2

FA2.2B.02

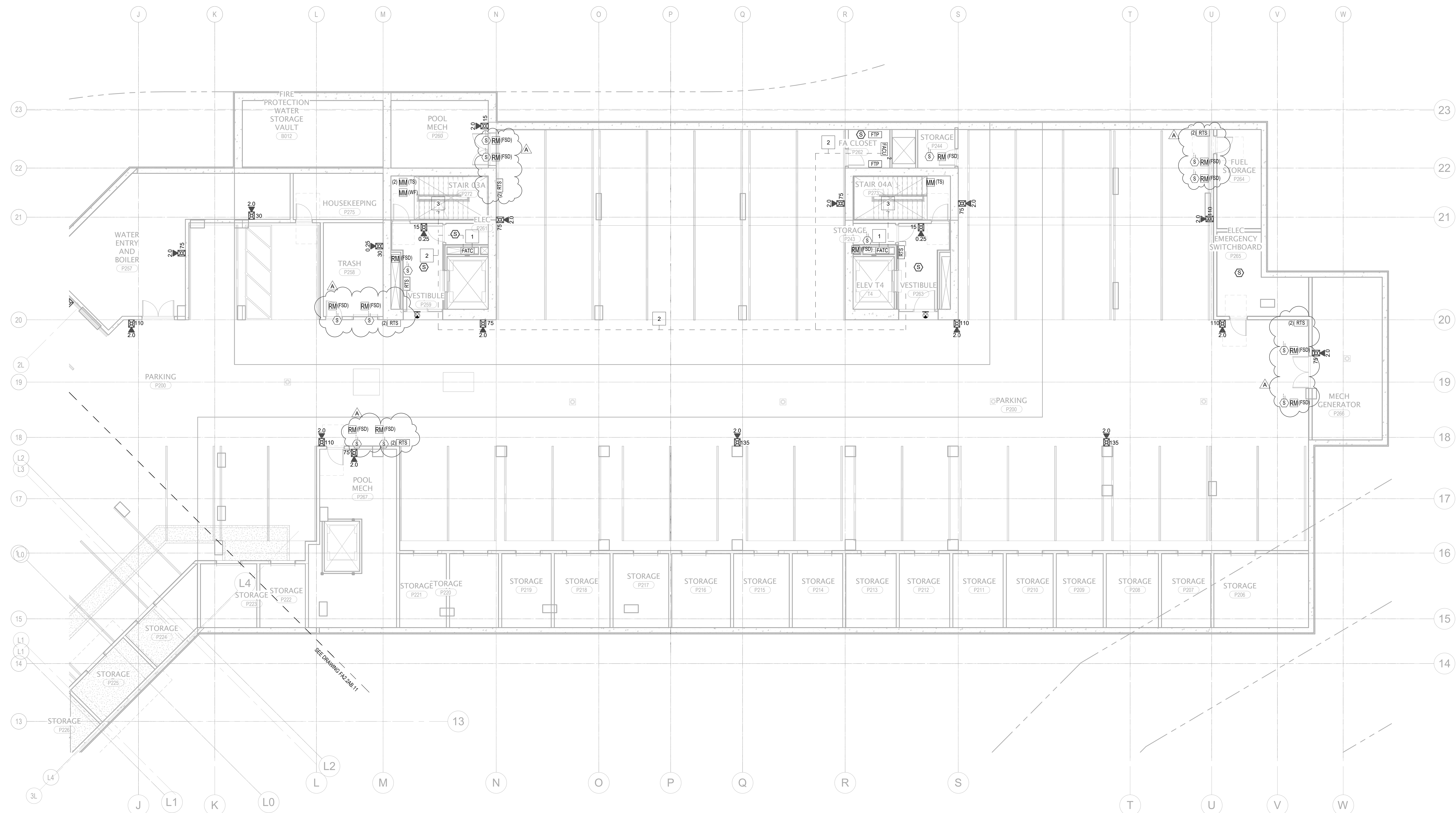

1 TOWER B - PARKING LEVEL 2 - FA
1/8" = 1'-0"

