

159 South Jackson St, Suite 600
Seattle, Washington 98104 USA

Olson Kundig

Project: **SOMMET BLANC**
33300 Marsac Ave (B2 East Parcel)
County: Clark; Loc: 84060

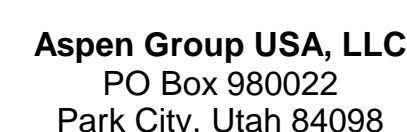

Pool Consultant
Cloward H2O
2696 N University Ave., Suite 290
Provo, UT 84604

Landscape Architect
EPG Design
6949 South High Tech Drive, Suite 10
Midvale, Utah 84047

Specifications Writer
Friday Group
88 Mainelli Road
Middlebury, VT

Code Consultant
Holmes
600 1st Avenue, Suite 200A
Seattle, WA 98104

Fire Protection Engineer
Jensen Hughes
One Research Drive, Suite 305C
Westborough, MA 01581

Vertical Transportation Consultant
Lerch Bates
19515 North Creek Parkway, Suite 300
Bothell, WA 98011

Structural Engineer
Magnusson Klemencic Associates
1301 5th Ave, Suite 3200
Seattle, WA 98101

Lighting Designer
O-
1319 SE MLK Blvd, Suite 210
Portland, Oregon 97219

Building Envelope Consultant
RDH
2101 N 34th St
Seattle, WA 98103

Accessibility Consultant
Studio Pacifica
2144 Westlake Ave N, Suite F
Seattle, WA 98109

MEP Engineer
WSP USA
1001 Fourth Ave., Suite 3100
Seattle, WA 98154

principal architect _____
project manager _____
drawn by _____
checked by Checker
job no. _____
date 5/31/2024

revisions

K 01/17/2025 ASI 008

no.	date	t
-----	------	---

IFC Set 3 of 3
5/31/2024

TOWER B - LVL B
ELECTRICAL LIGHTING
PLAN

E3.2B.01

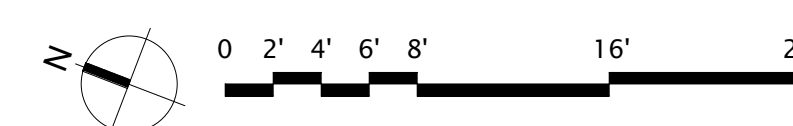
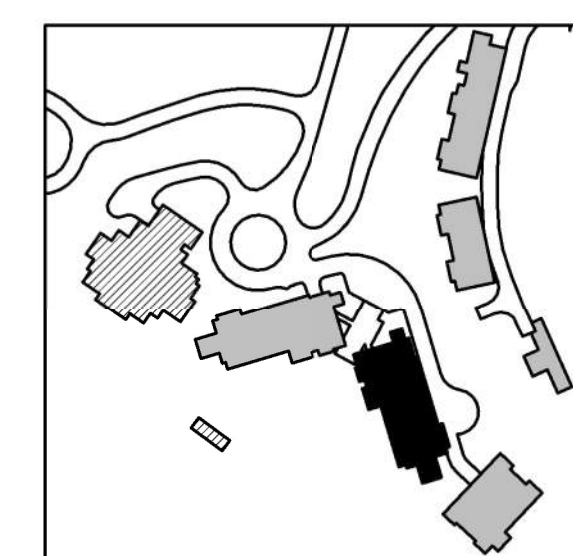

1 TOWER B LEVEL B1 ELECTRICAL LIGHTING RCP
SCALE: 1/8" = 1'-0"

SCALE: 1/8" = 1'-0"