

Olson Kundig

project;
SOMMET BLANC
33300 Marsac Ave (B2 East Parcel)
Grand Ciel, Utah 84080

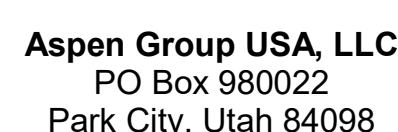

MEP Engineer
WSP USA
1001 Fourth Ave., Suite 3100
Seattle, WA 98154

N	05/21/2025	ASI 011
2	5/31/2024	IFC 3

no.	date	
-----	------	--

IFC Set 3 of 3
5/31/2024

TOWER A/B ELECTRICAL
LIGHTING PLAN - UNIT P

E3.4.P

SHEET NOTES:

- A. DRAWINGS ARE INTENDED TO SHOW GENERAL ARRANGEMENT, DESIGN AND EXTENT OF WORK AND ARE DIAGRAMMATIC. DRAWINGS ARE NOT INTENDED TO SHOW EXACT LOCATIONS EXCEPT WHERE DIMENSIONS ARE SHOWN. ELECTRICAL WORK IS SHOWN ON PLANS USING STANDARD INDUSTRY SYMBOLS. BEFORE ORDERING MATERIALS OR COMMENCEMENT WITH WORK, VERY MEASUREMENTS PERTAINING THERETO AND ASSUME RESPONSIBILITY THEREFOR. ANY SUBSTANTIAL DIFFERENCES BETWEEN DRAWINGS AND CONDITIONS IN THE FIELD SHALL BE SUBMITTED TO THE CONSTRUCTION SUPERVISOR FOR CONSIDERATION. THE CONTRACTOR SHALL BE RESPONSIBLE FOR ALL WORK PERFORMED INCLUDES LABOR, MATERIALS AND EQUIPMENT REQUIRED TO INSTALL A COMPLETE ELECTRICAL SYSTEM AS INDICATED ON DRAWINGS AND SPECIFICATIONS.
- C. PROVIDE EXIST CABLES AND CONNECT EXIST SYSTEMS AND LUMINAIRES NOTED AS EMERGENCY OR EMERGENCY POWERED EQUIPMENT ON PLANS.
- D. REFER TO LUMINAIRE SCHEDULE FOR INFORMATION.
- E. FIXTURE CATALOG NUMBERS ARE SUBJECT TO CHANGE BY MANUFACTURER. VERIFY FIXTURE CATALOG NUMBERS FOR ACCURACY.
- F. DESCRIBE SIZES AND POWER REQUIREMENTS FOR EQUIPMENT PROVIDED BY OTHERS.
- G. ELECTRICAL CONDUITS IN FINISHED SPACES SHALL BE LOCATED, COORDINATE WITH MECHANICAL AND USE OF FINISHED SPACES. LOCATIONS OF ELECTRICAL JUNCTION BOXES IN FINISHED SPACES SHALL BE APPROVED BY ARCHITECT PRIOR TO ROUGH-IN.
- H. COORDINATE REMOTE DRYER MOUNTING LOCATIONS WITH ARCHITECT PRIOR TO ROUGH IN.
- I. COORDINATE LUMINAIRE VOLTAGE WITH ARCHITECT AND OWNER PRIOR TO PURCHASE AND INSTALLATION TYPICAL FOR ALL-UNIT LIGHTING.
- J. CONFIRM WITH CLIENT AND OWNER ON CEILING TYPE FINISH UPDATES PRIOR TO PURCHASE AND INSTALLATION.

NUMBERED NOTES:

- 1 LIGHT FIXTURE LOCATED IN CLOSETS ARE TO BE CONTROLLED BY CLOSET DOOR JAM SWITCH.
2 SUPPLY AND INSTALL LUTRON RADIO RA2 SYSTEM TO PROVIDE PARTIAL LIGHTING CONTROL IN THE RESIDENTIAL UNITS. MASTER
BEDROOM (DENOTED AS BED 1) AND ALL ROOMS WITH MORE THAN THREE (3) LIGHTING CONTROL ZONES ARE TO BE
CONTROLLED BY THE LUTRON RADIO RA2 SYSTEM. ALL ROOMS WITH THREE (3) LIGHTING CONTROL ZONES OR LESS ARE TO BE
CONTROLLED BY LOCAL DIMMERS.
3 REFER TO ARCHITECTURAL DRAWINGS AND ELEVATIONS FOR EXACT DIMENSION AND MOUNTING LOCATION OF LIGHT FIXTURE
TYPE L04. COORDINATE WITH MILLWORK CONTRACTOR PRIOR TO INSTALLATION.

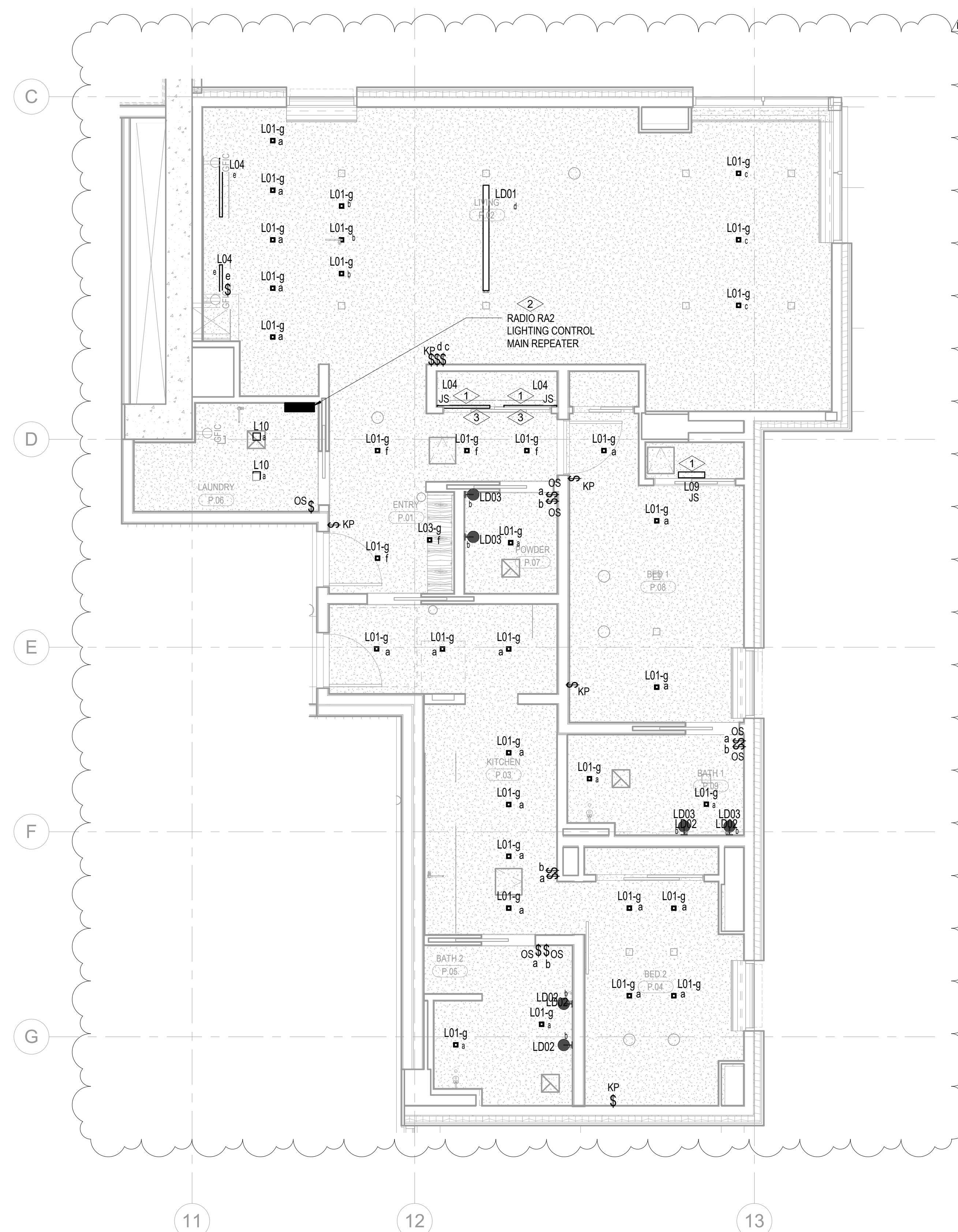

1 TOWER A/B - ELECTRICAL LIGHTING PLAN - UNIT P
SCALE: 1/4" = 1'-0"

