

159 South Jackson St., Suite 600
Seattle, Washington 98104 USA
+1 206 624 5670 discounting.com

Olson Kundig

SOMMET BLANC
9300 Marsac Ave (B2 East Parcel)
Park City, Utah 84060



PE Engineer
PE USA
101 Fourth Ave., Suite 3100
Seattle, WA 98154

principal architect _____
project manager _____
drawn by _____
checked by Checker _____
job no. _____
date 11/18/2022

Revisions:

no.	date	by
-----	------	----

ISSUE FOR
CONSTRUCTION
11/18/2022

POWER C - LVL 1
ELECTRICAL LIGHTING
PLAN

E3.3C.11

DRAWINGS ARE INTENDED TO SHOW GENERAL ARRANGEMENT, DESIGN, AND EXTENT OF WORK AND ARE DIAGRAMMATIC. DRAWINGS ARE NOT INTENDED TO SHOW EXACT LOCATION OF WORK OR TO BE USED FOR CONSTRUCTION. MATERIALS TO BE SHOWN ON PLANS USING STANDARD INDUSTRY SYMBOLS. BEFORE ORDERING MATERIALS OR COMMENCEMENT WITH WORK, VERIFY MEASUREMENTS PERFORMED THEREON AND CORRECT ANY DISCREPANCIES. ALL WORK SHALL BE IN ACCORDANCE WITH THE DRAWINGS AND CONDITIONS IN THE FIELD SHALL BE SUBMITTED TO THE CONSTRUCTION SUPERVISOR FOR APPROVAL. GENERATION OF THE DRAWINGS SHALL BE THE RESPONSIBILITY OF THE CONTRACTOR. THE CONTRACTOR WILL BE REQUIRED TO OBTAIN ALL NECESSARY MATERIALS, AND EQUIPMENT REQUIRED TO INSTALL A COMPLETE ELECTRICAL SYSTEM AS INDICATED ON DRAWINGS AND SPECIFICATIONS. THE CONTRACTOR SHALL BE RESPONSIBLE FOR OBTAINING ALL NECESSARY PERMITS AND EMERGENCY POWER SOURCE AS NOTED ON PLANS.

REFER TO LUMINAIRE SCHEDULE FOR INFORMATION

VERIFY ALL DIMENSIONS AND CONDITIONS AS CHANGED BY MANUFACTURER. VERIFY FIGURE CATALOG NUMBERS FOR ACCURACY.

VERIFY EQUIPMENT SIZES AND POWER REQUIREMENTS FOR EQUIPMENT PROVIDED BY OTHERS.

ELECTRICAL CONDITIONS IN FINISHED SPACES SHALL BE CONCEALED. COORDINATE WITH OTHER TRADES AND USE CHASES AND CEILING SPACES. LOCATIONS OF ELECTRICAL JUNCTION BOXES IN FINISHED SPACES SHALL BE APPROVED BY ARCHITECT PRIOR TO ROUGH-IN.

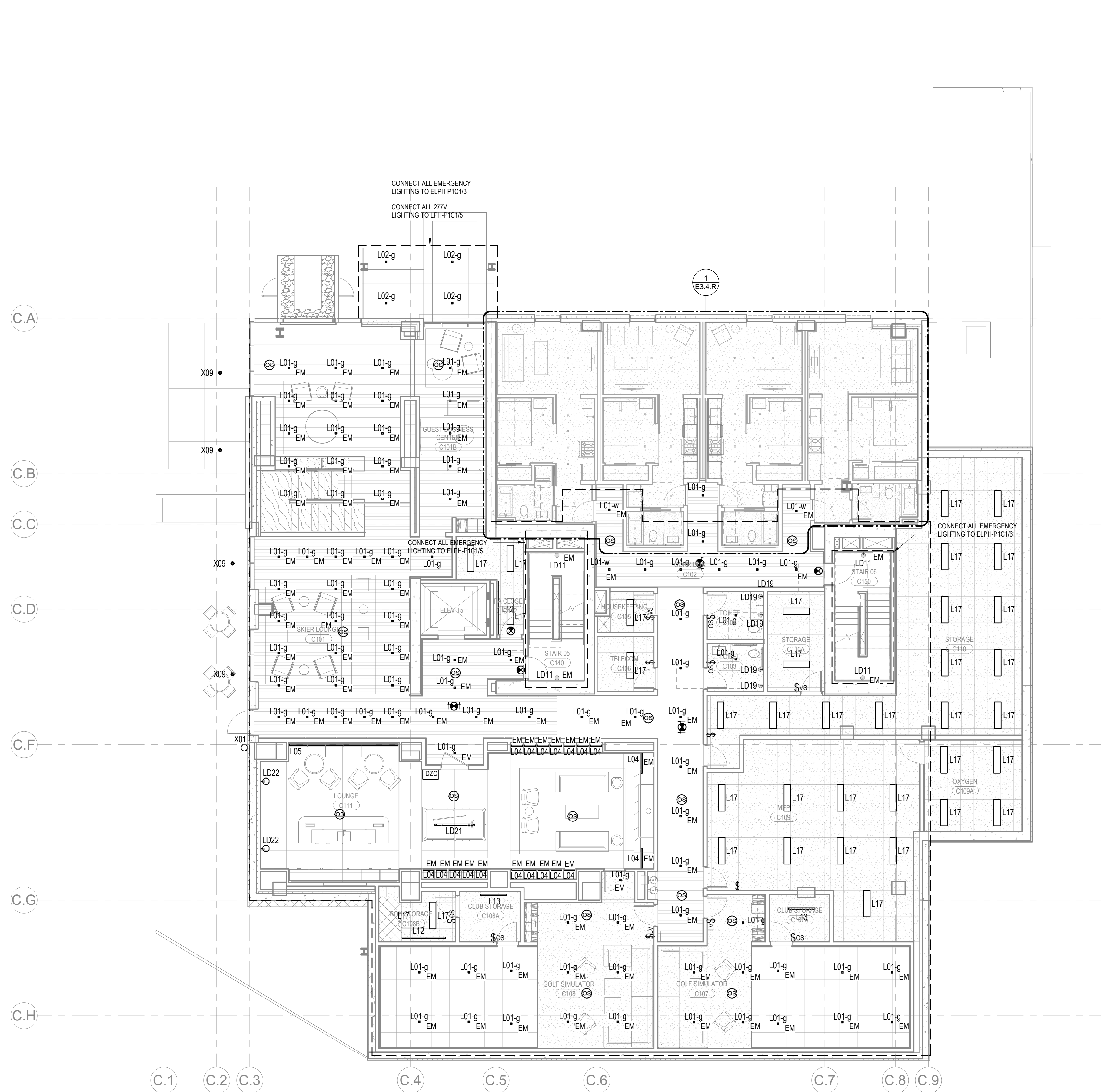

1 LEVEL 1 - LIGHTING PLAN
SCALE: 1/8" = 1'-0"

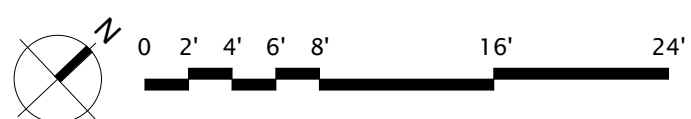
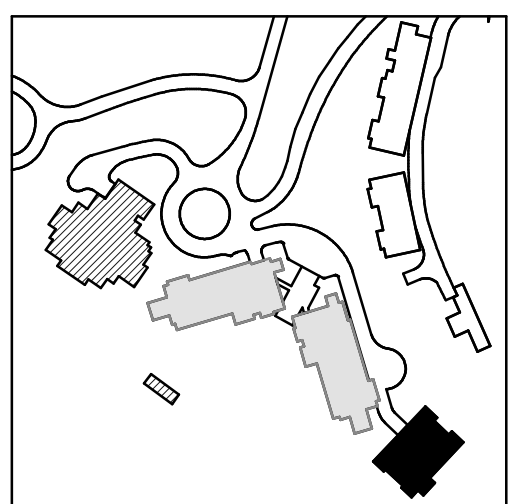

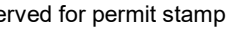

159 South Jackson St, Suite 600
Seattle, Washington 98104 USA
+1 206 624 5670 olsonlundig.com

Olson Kundig

project:
SOMMET BLANC
9300 Marsac Ave (B2 East Parcel)
Park City, Utah 84060

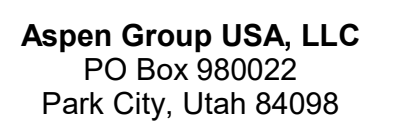

no.	date	b
-----	------	---

ISSUE FOR
CONSTRUCTION
11/18/2022

E3.3C.16

DRAWINGS ARE INTENDED TO SHOW GENERAL ARRANGEMENT, DESIGN AND EXTENT OF WORK AND ARE DIAGRAMMATIC. DRAWINGS ARE NOT INTEND TO SHOW EXACT LOCATION OF EQUIPMENT OR OTHER FEATURES UNLESS SPECIFICALLY NOTED ON PLANS USING STANDARD INDUSTRY SYMBOLS. BEFORE ORDERING MATERIALS OR COMMENCEMENT WITH WORK, VERIFY MEASUREMENTS PERTAINING THERE TO AND CORRECT ANY DISCREPANCIES PRIOR TO PROCEEDING. ALL DIMENSIONS SHOWN IN THE DRAWINGS AND CONDITIONS IN THE FIELD SHALL BE SUBMITTED TO THE CONSTRUCTION MANAGER FOR CONSIDERATION BEFORE PROCEEDING WITH ANY WORK. IF IT IS DETERMINED THAT A CHANGE TO THE ORIGINAL DESIGN OR EQUIPMENT REQUIRED TO INSTALL A COMPLETE ELECTRICAL SYSTEM AS INDICATED ON DRAWINGS AND SPECIFICATIONS, THE CONTRACTOR MUST OBTAIN WRITTEN APPROVAL FROM THE ENGINEER. NOTES AS EMERGENCY TO ELECTRICITY POWER SOURCE AS INDICATED ON PLANS.

REFER TO LAMINAIRE SCHEDULE FOR INFORMATION.

VERIFY EQUIPMENT SIZES AND VOLTAGES TO CHANGE BY MANUFACTURER. VERIFY FITTURE CATALOG NUMBERS FOR ACCURACY.

VERIFY EQUIPMENT SIZES AND POWER REQUIREMENTS FOR EQUIPMENT PROVIDED BY OTHERS.

ELECTRICAL CONDITIONS IN FINISHED SPACES SHALL BE CONCEALED. COORDINATE WITH OTHER TRADES AND USE CHASES AND CHESLING SPLICES. LOCATIONS OF ELECTRICAL JUNCTION BOXES IN FINISHED SPACES SHALL BE APPROVED BY ARCHITECT PRIOR TO ROUGH-IN.

